

# PRODUCT RANGE

## 2023

the  
kitchen  
sink  
company

PERRIN & ROWE  
MAYFAIR LONDON

in sink erator®  
solutions for sinks

abode



*Regis*

 **PYRAMIS**  
Kitchen Inspirations

LANSDOWNE

ORIGINAL  
**CRAMER**®

30 YEARS OF SUPPLYING THE FINEST SINKS & TAPS



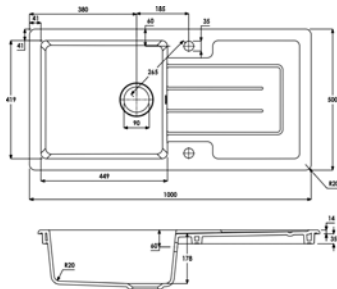

**AW1040**  
Acton Single bowl & Drainer (Reversible)  
EXT – 1000 x 500mm  
Base Unit – 600mm  
WASTE – Waste & Plumbing Kit included

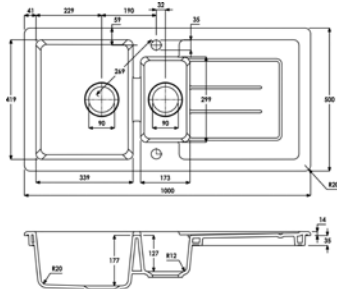

**AW1041**  
Acton 1.5 Bowl & Drainer (Reversible)  
EXT – 1000 x 500mm  
Base Unit – 600mm  
WASTE – Waste & Plumbing Kit included

MILFORD CERAMIC INSET SINKS

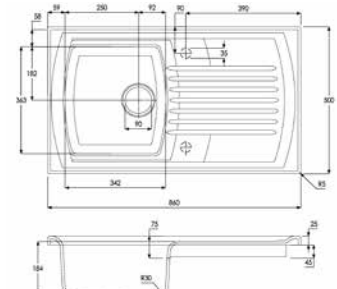

**AW1042**  
Milford Single Bowl & Drainer (Reversible)  
EXT – 860 x 500 x 220mm  
Base Unit – 450mm  
WASTE – Waste & Plumbing Kit included

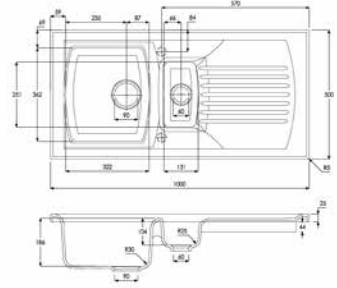

**AW1043**  
Milford 1.5 Bowl & Drainer (Reversible)  
EXT – 1000 x 500 x 220mm  
Base Unit – 600mm  
WASTE – Waste & Plumbing Kit included

PROVINCIAL CERAMIC SINKS

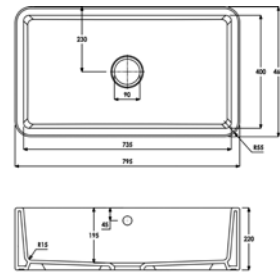

**AW1020**  
Provincial Large Single Bowl  
EXT – 795 x 460 x 220mm  
Base Unit – 800mm  
WASTE – Waste & Plumbing Kit included

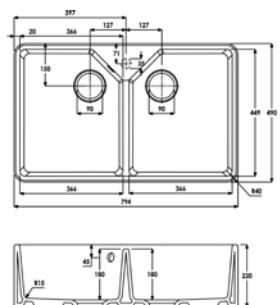

**AW1021**  
Provincial Large Double Bowl  
EXT – 795 x 490 x 220mm  
Base Unit – 800mm  
WASTE – Waste & Plumbing Kit included

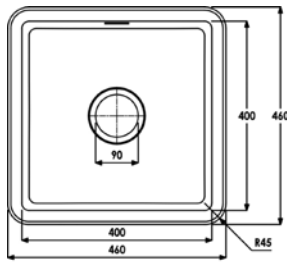

**AW1030**  
Sandon Single Bowl  
EXT – 460 x 460mm  
Base Unit – 600mm  
WASTE – Waste & Plumbing Kit included

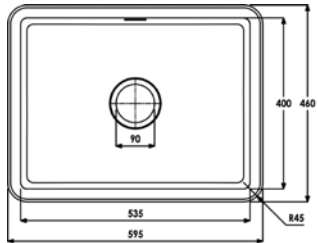

**AW1031**  
Sandon Large Single Bowl  
EXT – 595 x 460mm  
Base Unit – 800mm  
WASTE – Waste & Plumbing Kit included

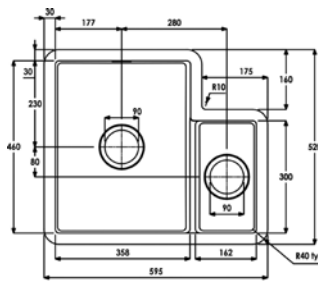

**AW1032**  
Sandon 1.5 Bowl (LH Main Bowl)  
EXT – 595 x 520mm  
Base Unit – 800mm  
WASTE – Waste & Plumbing Kit included

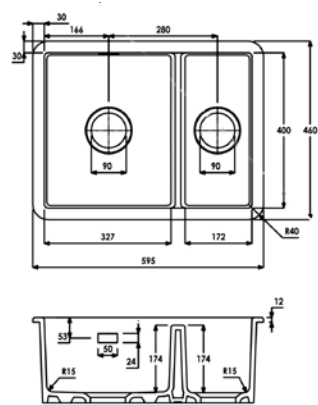

**AW1033**  
Sandon 1.5 Bowl (LH Main Bowl) with Full Depth Half Bowl  
EXT – 595 x 460mm  
Base Unit – 800mm  
WASTE – Waste & Plumbing Kit included



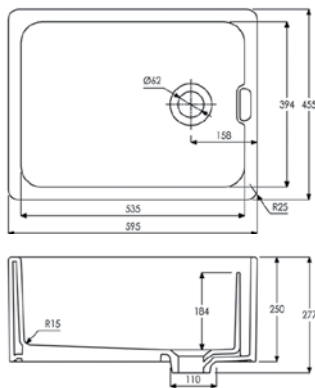

**AW1022**  
Ceramic Belfast single bowl  
EXT – 595 x 455 x 250mm  
Base Unit 600mm  
WASTE – included

DUNE BLACK & WHITE GRANITE INSET SINKS

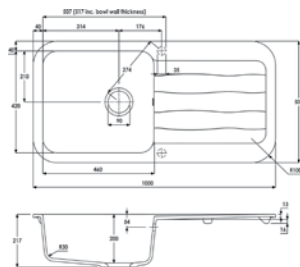

**AW3140**  
Black Granite single bowl & drainer (Reversible)  
EXT – 1000 x 500 x 217mm  
WASTE – 90mm Orbital Strainer included

**AW3141**  
White Granite single bowl & drainer (Reversible)

**AW3144**  
Metallic Grey single bowl & drainer (Reversible)

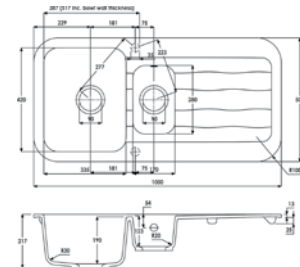

**AW3142**  
Black Granite 1.5 bowl & Drainer (Reversible)  
EXT – 1000 x 500 x 217mm  
WASTE – 2 x 90mm Orbital Strainers included

**AW3143**  
White Granite 1.5 bowl & Drainer (Reversible)

**AW3145**  
Metallic Grey 1.5 bowl & drainer Reversible

ASPEKT BLACK & WHITE GRANITE INSET SINKS

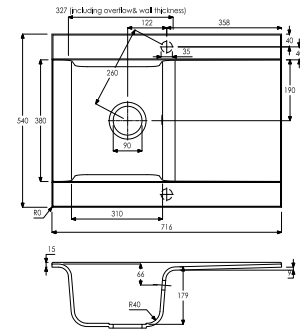

**AW3001**  
Black Granite single bowl & drainer (Reversible)  
EXT – 716 x 540 x 205  
WASTE – 90mm Orbital Strainer included

**AW3101**  
White Granite single bowl & drainer (Reversible)

**AW3002**  
Black Granite 1.5 bowl & Drainer (Reversible)

**AW3102**  
White Granite 1.5 bowl & Drainer (Reversible)

All coloured sinks are special orders, please refer T&C's on back page

Ceramic sink dimensions may vary +/- 2% to 3% due to firing process, please do take this into account when making Bespoke furniture.

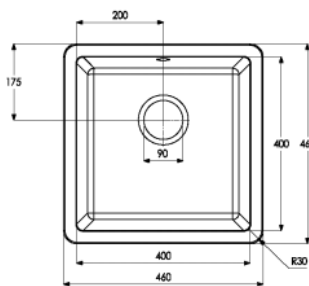

**AW3124**  
Black Metallic Single Bowl  
EXT - 460 x 460 x 220 mm  
BASE UNIT - 500 mm  
WASTES - 90 mm Orbital Strainers included

**AW3125**  
White Single Bowl

**AW3133**  
Metallic Grey Single Bowl

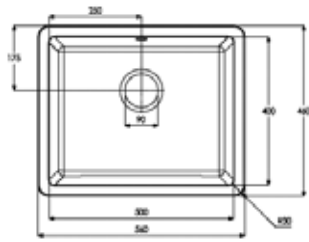

**AW3126**  
Black Metallic Large Bowl  
EXT - 560 x 460 x 225 mm  
BASE UNIT - 600 mm  
WASTES - 90 mm Orbital Strainers included

**AW3127**  
White Large Bowl

**AW3134**  
Metallic Grey Large Bowl

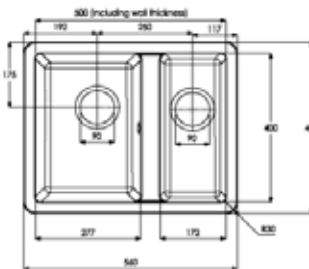

**AW3128**  
Black Metallic 1.5 Bowl  
EXT - 560 x 460 x 220 mm  
BASE UNIT - 600 mm  
WASTES - 2 x 90 mm Orbital Strainers included

**AW3129**  
White 1.5 Bowl

**AW3135**  
Metallic Grey 1.5 Bowl

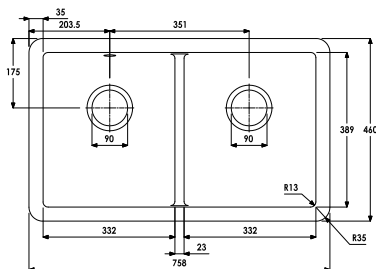

**AW3165**  
Metallic Grey Granite  
EXT - 758 x 460 x 220 mm  
BASE UNIT - 800 mm  
WASTES - 2 x 90 mm  
Orbital Strainers included

**AW3166**  
Metallic Black Granite  
EXT - 758 x 460 x 220 mm  
BASE UNIT - 800 mm  
WASTES - 2 x 90 mm  
Orbital Strainers included

DENTON GREY METALLIC GRANITE UNDERMOUNT SINK

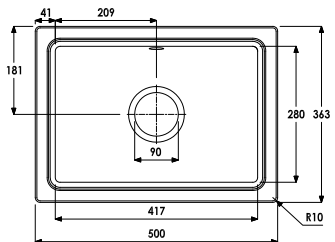

**AW3167**  
Grey Metallic Granite  
EXT - 500 x 363 x 198 mm  
BASE UNIT - 450/650 mm  
WASTES - 1 x 90 mm  
Orbital Strainers included

All coloured sinks are special orders, please refer T&C's on back page



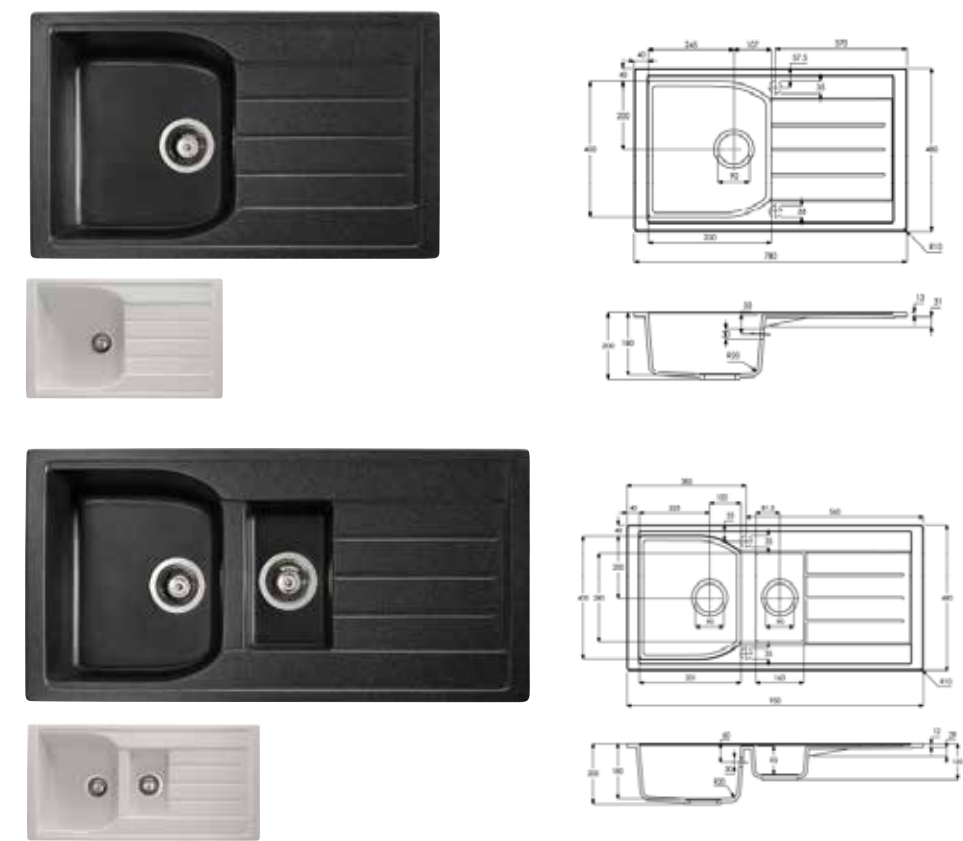

**AW3112**  
Black Metallic Single Bowl & Drainer (Reversible)  
EXT - 780 x 480 x 200 mm  
BASE UNIT - 450 mm  
WASTES - 90 mm Orbital Strainers included

**AW3113**  
Black Metallic 1.5 Bowl & Drainer (Reversible)  
EXT - 950 x 480 x 200 mm  
BASE UNIT - 600 mm  
WASTES - 2 x 90 mm Orbital Strainers included

**AW3114**  
White Single Bowl & Drainer

**AW3115**  
White 1.5 Bowl & Drainer

XCITE Black Metallic, White & Granite Inset Sinks

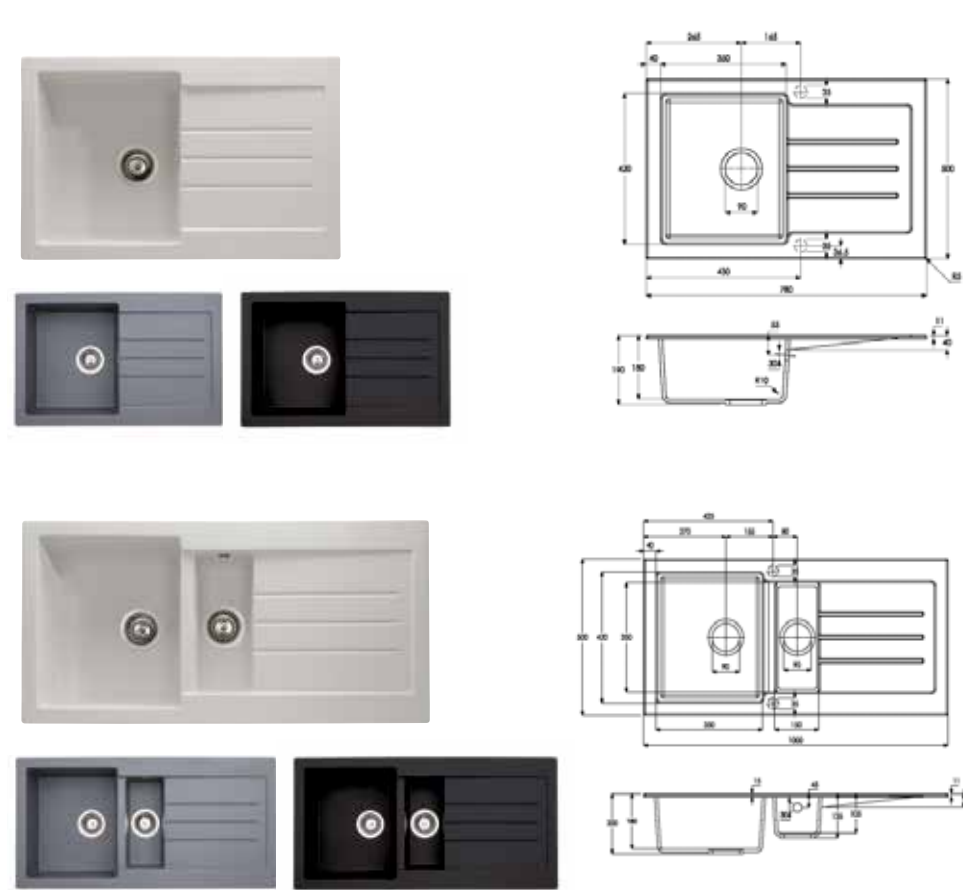

**AW3120**  
White Single Bowl & Drainer (Reversible)  
EXT - 780 x 500 x 190 mm  
BASE UNIT - 450 mm  
WASTES - 90 mm Orbital Strainers included

**AW3168**  
Black Single Bowl & Drainer (Reversible)

**AW3161**  
Metallic Grey Single Bowl & Drainer (Reversible)  
EXT - 780 x 500 x 190 mm  
BASE UNIT - 450 mm  
WASTES - 90 mm Orbital Strainers included

**AW3121**  
White 1.5 Bowl & Drainer (Reversible)  
EXT - 1000 x 500 x 200 mm  
BASE UNIT - 600 mm  
WASTES - 2 x 90 mm Orbital Strainers included

**AW3169**  
Black 1.5 Bowl & Drainer (Reversible)

**AW3162**  
Metallic Grey 1.5 Bowl & Drainer (Reversible)  
EXT - 1000 x 500 x 200 mm  
BASE UNIT - 600 mm  
WASTES - 2 x 90 mm Orbital Strainers included

All coloured sinks are special orders, please refer T&C's on back page

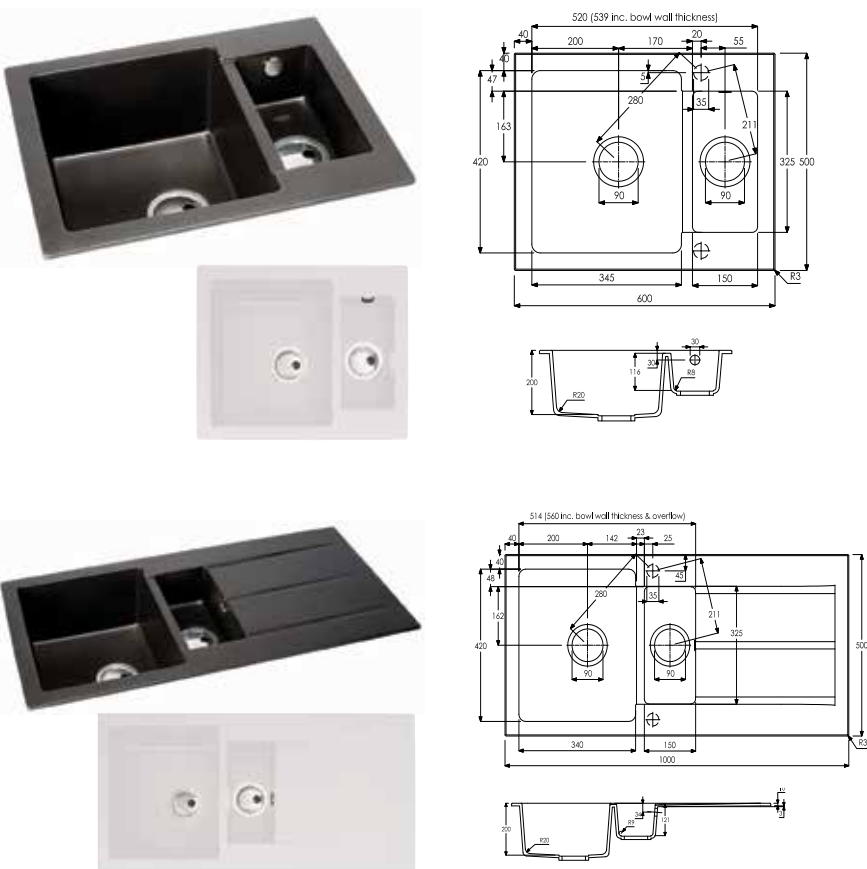

**AW3005**  
Black 1.5 Bowl (Reversible)  
EXT - 600 x 500 x 220 mm  
BASE UNIT - 600 mm  
WASTE - 90 mm Orbit Strainer included  
ACCESSORIES - AX2017, AX2502, AX2503

**AW3105**  
White 1.5 bowl no drainer

**AW3006**  
Black 1.5 Bowl & Drainer (Reversible)  
EXT - 1000 x 500 x 220 mm  
BASE UNIT - 600 mm  
WASTE - 90 mm Orbit Strainer included  
ACCESSORIES - AX2015, AX2017, AX2500, AX2502, AX2503

**AW3106**  
White 1.5 bowl and drainer

**AW3164**  
Grey Metallic 1.5 bowl and drainer

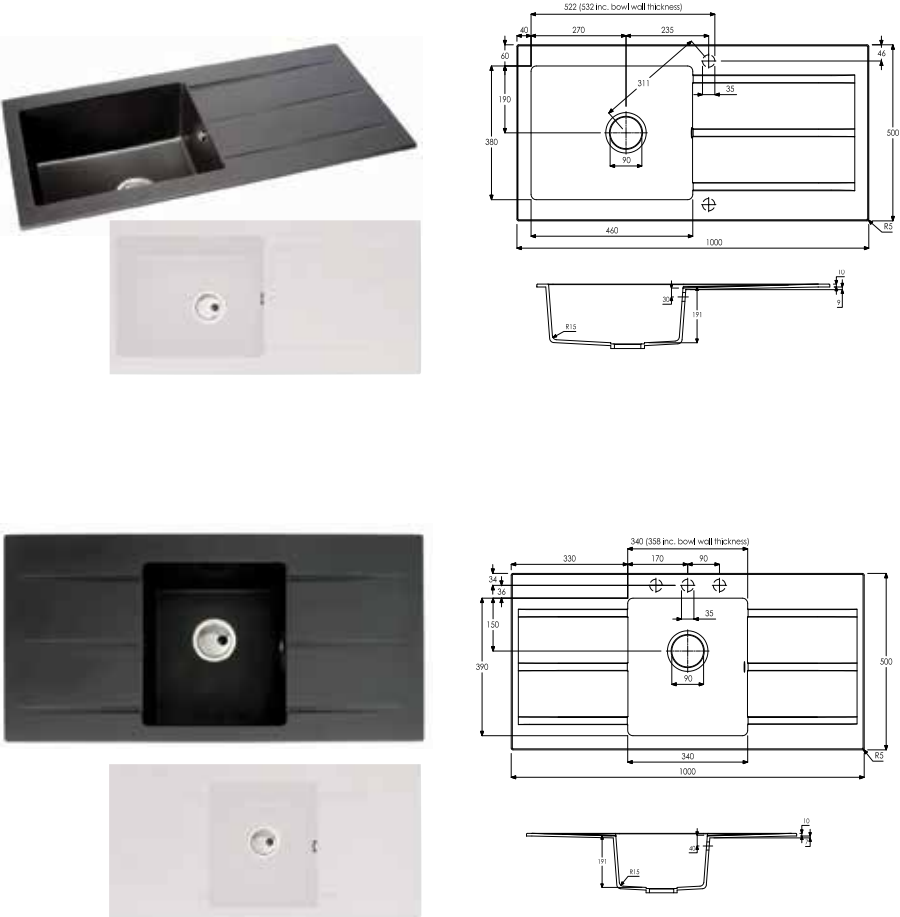

**AW3007**  
Black Single Bowl & Drainer(Reversible)  
EXT - 1000 x 500 x 220 mm  
BASE UNIT - 600 mm  
WASTE - 90 mm Orbit Strainer included  
ACCESSORIES - AX2017, AX2500, AX2502, AX2503

**AW3107**  
White 1 bowl and drainer

**AW3163**  
Grey Metallic 1 bowl and drainer

**AW3008**  
Black Single Bowl & Double Drainer  
EXT - 1000 x 500 x 220 mm  
BASE UNIT- 450 mm  
WASTE - 90 mm Orbit Strainer included  
ACCESSORIES - AX2017, AX2502, AX2503

**AW3108**  
White 1 bowl double drainer

All coloured sinks are special orders, please refer T&C's on back page

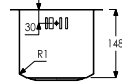
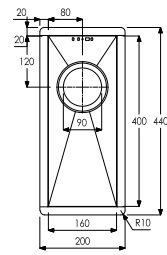

#### AW5007

MATRIX R0 Single Half Bowl  
EXT - 200 x 440 x 155 mm  
BASE UNIT - 450 mm  
WASTE - 90mm Orbit Strainer included  
ACCESSORIES - AX1503, AX2501,  
AX2502, AX2503

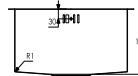
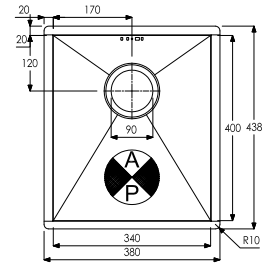

#### AW5008

MATRIX R0 Main Bowl (400mm)  
EXT - 380 x 438 x 205 mm  
BASE UNIT - 450 mm  
WASTE - 90 mm Orbit Strainer included  
ACCESSORIES - AX2501, AX3006,  
AX2502, AX2503

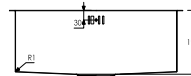
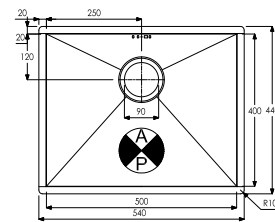

#### AW5009

MATRIX R0 Large Single Half Bowl  
EXT - 540 x 440 x 205 mm  
BASE UNIT - 600 mm  
WASTE - 90 mm Orbit Strainer included  
ACCESSORIES - AX1503, AX2501,  
AX3007, AX2502, AX2503

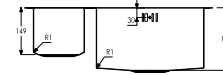
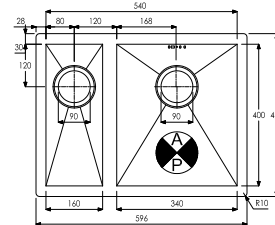

#### AW5010-2

MATRIX R0 1.5 Bowl (RH main bowl)  
EXT - 596 x 460 x 205 mm  
BASE UNIT - 600 mm  
WASTE - 90 mm Orbit Strainer included  
ACCESSORIES - AX1503, AX2501,  
AX3006, AX2502, AX2503

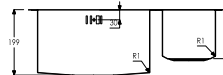
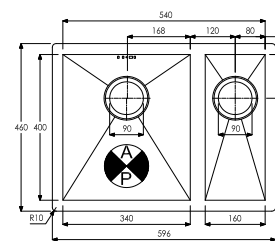

#### AW5011-2

MATRIX R0 1.5 Bowl (LH main bowl)  
EXT - 596 x 460 x 205 mm  
BASE UNIT - 600 mm  
WASTE - 90 mm Orbit Strainer included  
ACCESSORIES - AX1503, AX2501,  
AX3006, AX2502, AX2503

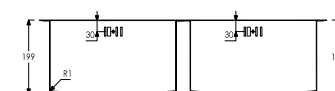
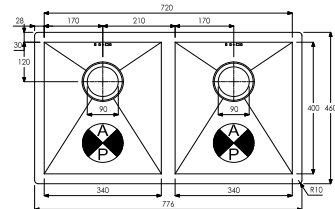

#### AW5012-2

MATRIX R0 Double Bowl  
EXT - 776 x 460 x 205 mm  
BASE UNIT - 800 mm  
WASTE - 90 mm Orbit Strainer included  
ACCESSORIES - AX1503, AX2501,  
AX3006, AX2502, AX2503

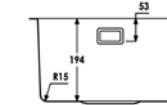
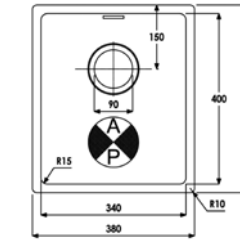

#### AW5121

Matrix R15 Single Bowl  
EXT - 380 x 440 x 202mm  
Base Unit - 500mm  
WASTE - 90mm Orbital Strainer &  
Plumbing Kit included

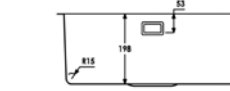
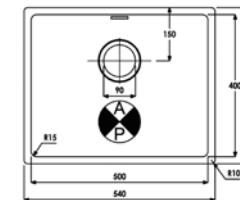

#### AW5122

Matrix R15 Large Single Bowl  
EXT - 540 x 440 x 205mm  
Base Unit - 600mm  
WASTE - 90mm Orbital Strainer &  
Plumbing Kit included

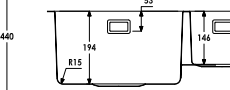
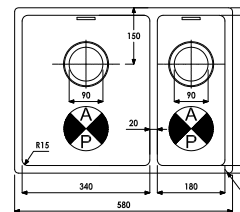

#### AW5124

Matrix R15 1.5 Bowl LH Main Bowl  
EXT - 570 x 440 x 202mm  
Base Unit - 800mm  
WASTE - 90mm Orbital Strainer &  
Plumbing Kit included

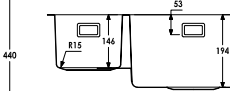
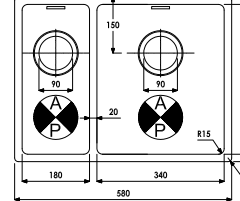

#### AW5126

Matrix R15 1.5 Bowl RH Main Bowl  
EXT - 570 x 440 x 202mm  
Base Unit - 800mm  
WASTE - 90mm Orbital Strainer &  
Plumbing Kit included

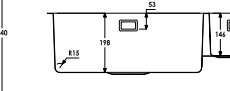
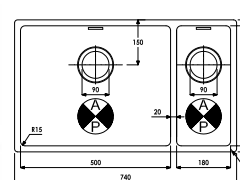

#### AW5125

Matrix R15 Large 1.5 Bowl  
LH Main Bowl  
EXT - 730 x 440 x 205mm  
Base Unit - 800mm  
WASTE - 90mm Orbital Strainer &  
Plumbing Kit included

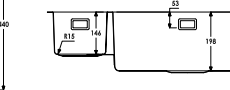
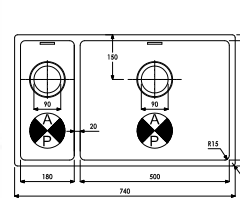

#### AW5127

Matrix R15 Large 1.5 Bowl  
RH Main Bowl  
EXT - 730 x 440 x 205mm  
Base Unit - 800mm  
WASTE - 90mm Orbital Strainer &  
Plumbing Kit included

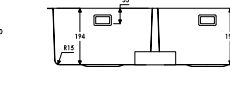
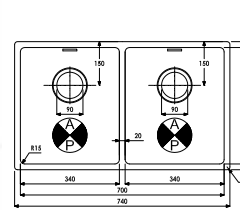

#### AW5123

Matrix R15 Double Bowl  
EXT - 740 x 440 x 202mm  
Base Unit - 800mm  
WASTE - 90mm Orbital Strainer &  
Plumbing Kit included

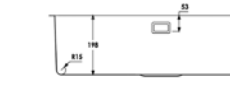
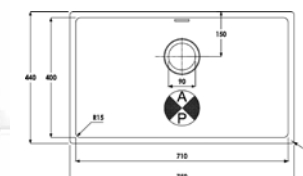

#### AW5128

Matrix R15 Large Single Bowl  
EXT - 750 x 440 x 202mm  
Base Unit - 800mm  
WASTE - 2 x 90mm Orbital Strainer &  
Plumbing Kit included



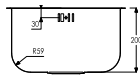
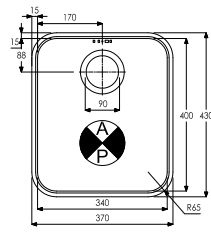

**AW5014**  
MATRIX R50 Main Bowl (400mm)  
EXT - 370 x 430 x 205 mm  
BASE UNIT - 450 mm  
WASTE - 90 mm Orbit Strainer included  
ACCESSORIES - AX2501, AX3009, AX2502, AX2503

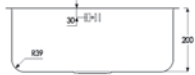
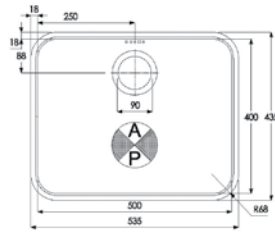

**AW5015**  
MATRIX R50 Large Single Bowl  
EXT - 535 x 435 x 205 mm  
BASE UNIT - 600 mm  
WASTE - 90 mm Orbit Strainer included  
ACCESSORIES - AX2501, AX2502, AX2503

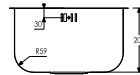
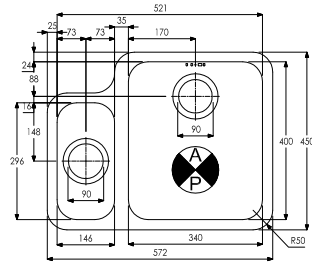

**AW5016**  
MATRIX R50 1.5 Bowl (RH Main Bowl)  
EXT - 572 x 450 x 205 mm  
BASE UNIT - 600 mm  
WASTE - 90 mm Orbit Strainer included  
ACCESSORIES - AX1502, AX2501, AX3009, AX2502, AX2503

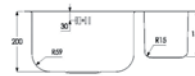
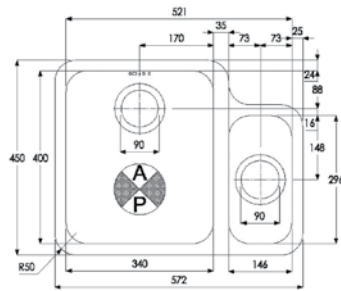

**AW5017**  
MATRIX R50 1.5 Bowl (LH Main Bowl)  
EXT - 572 x 450 x 205 mm  
BASE UNIT - 600 mm  
WASTE - 90 mm Orbit Strainer included  
ACCESSORIES - AX1502, AX2501, AX3009, AX2502, AX2503

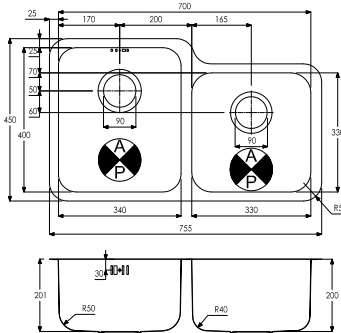

**AW5018**  
MATRIX R50 1.75 Bowl  
EXT - 755 x 450 x 205 mm  
BASE UNIT - 800 mm  
WASTE - 90 mm Orbit Strainer included  
ACCESSORIES - AX2500, AX3009, AX2502, AX2503

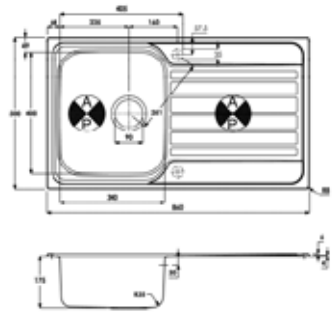

**AW5056**  
CONNEKT Single Bowl & Drainer (Reversible)  
EXT - 860 x 500 x 175 mm  
BASE UNIT - 450 mm  
WASTE - 90 mm Orbit Strainer included

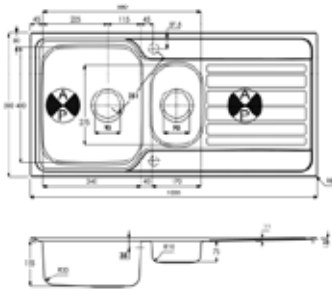

**AW5057**  
CONNEKT 1.5 Bowl & Drainer (Reversible)  
EXT - 1000 x 500 x 155 mm  
BASE UNIT - 600 mm  
WASTE - 2 x 90 mm Orbit Strainer included

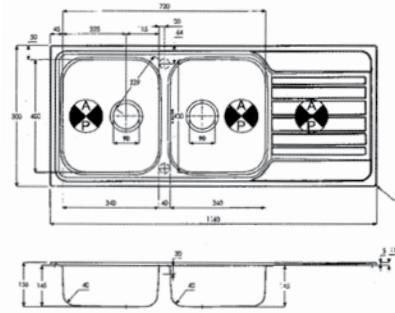

**AW5060**  
CONNEKT 2.0 Bowl & Drainer (Reversible)  
EXT - 1160 x 500 x 160 mm  
BASE UNIT - 800 mm  
WASTE - 2 x 90 mm Orbit Strainer included



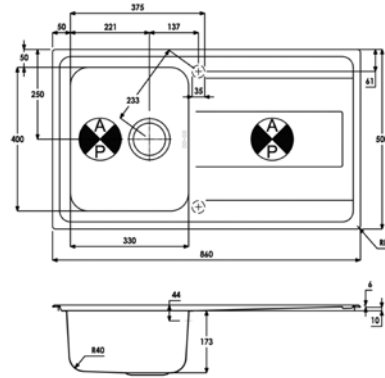

**AW5101**

Ixis Single Bowl & Drainer Compact  
EXT – 860 x 500 x 195mm  
Base Unit – 450mm  
WASTE - Waste & Plumbing Kit included

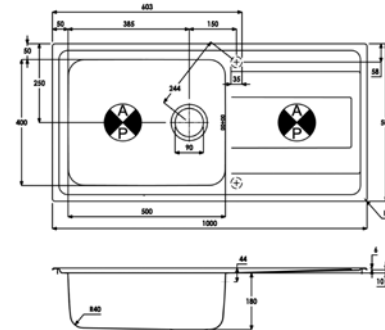

**AW5102**

Ixis Single Bowl & Drainer  
EXT – 1000 x 500 x 201mm  
Base Unit – 600mm  
WASTE - Waste & Plumbing Kit included

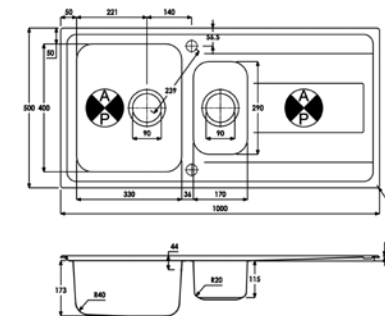

**AW5103**

Ixis 1.5 Bowl & Drainer Compact  
EXT – 1000 x 500 x 195mm  
Base Unit – 600mm  
WASTE - Waste & Plumbing Kit included

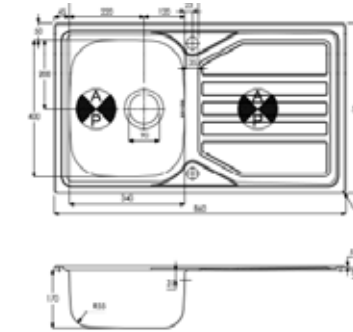

**AW5062**

MIKRO 1 Bowl & Drainer (Reversible)  
EXT - 860 x 500 x 170 mm  
BASE UNIT - 450 mm  
WASTE - 90 mm Orbit Strainer included

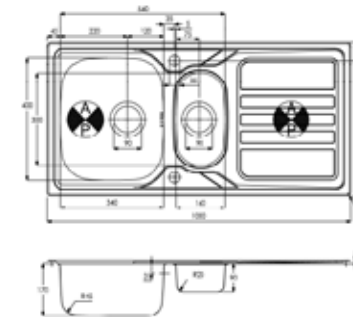

**AW5061**

MIKRO 1.5 Bowl & Drainer (Reversible)  
EXT - 1000 x 500 x 170 mm  
BASE UNIT - 600 mm  
WASTE - 2 x 90 mm Orbit Strainer included

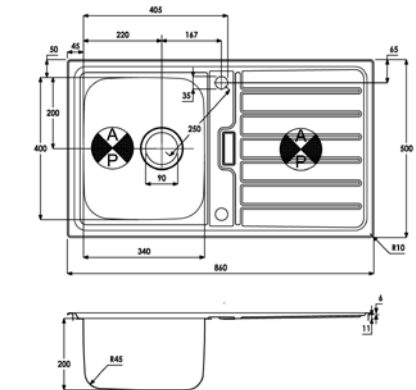

**AW5111**

Neron Single Bowl & Drainer Compact  
EXT – 860 x 500 x 220mm  
Base Unit – 500mm  
WASTE - Waste & Plumbing Kit included

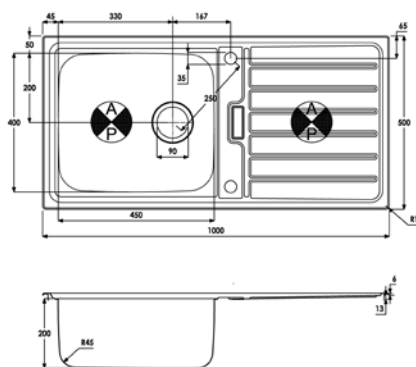

**AW5112**

Neron Single Bowl & Drainer  
EXT – 1000 x 500 x 219mm  
Base Unit – 600mm  
WASTE - Waste & Plumbing Kit included

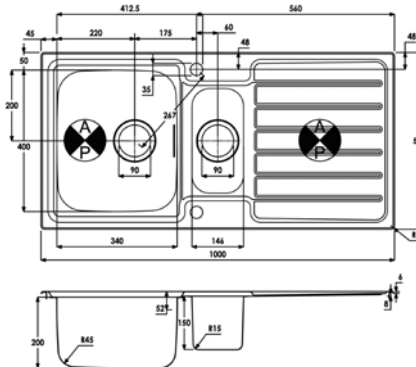

**AW5113**

Neron 1.5 Bowl & Drainer Compact  
EXT – 1000 x 500 x 218mm  
Base Unit – 600mm  
WASTE – Waste & Plumbing Kit included

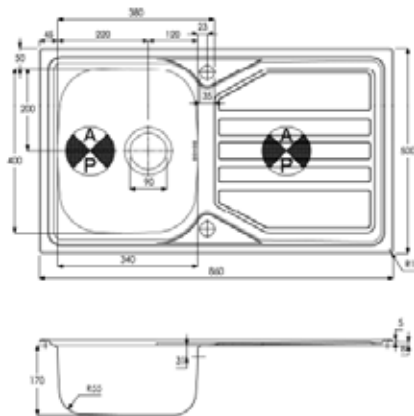

**AW5054**  
TRYDENT Single Bowl & Drainer (Reversible)  
EXT - 860 x 500 x 170 mm  
BASE UNIT - 450 mm  
WASTE - 90 mm Orbit Strainer included  
ACCESSORIES - AX2501, AX1011, AX3008, AX2014

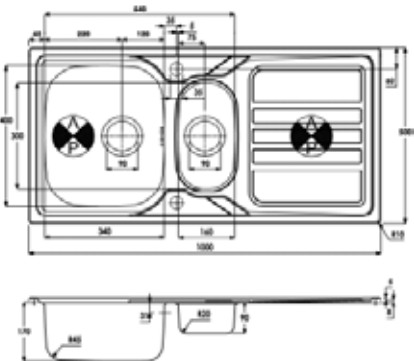

**AW5055**  
TRYDENT 1.5 Bowl & Drainer (Reversible)  
EXT - 1000 x 500 x 170 mm  
BASE UNIT - 600 mm  
WASTE - 2 x 90 mm Orbit Strainer included  
ACCESSORIES - AX2500, AX1011, AX3008, AX2014

VERVE STAINLESS STEEL INSET SINKS

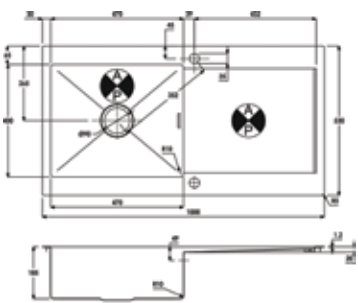

**AW5136**  
VERVE 1 Bowl & Drainer (Reversible)  
EXT - 1000 x 530 x 190 mm  
BASE UNIT - 600mm  
WASTE - 1 x 90 mm Orbit Strainer included

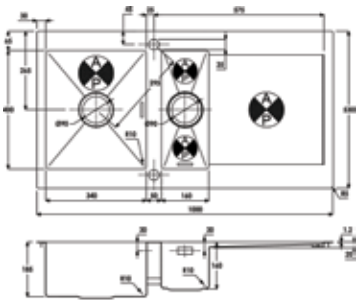

**AW5137**  
VERVE 1.5 Bowl & Drainer (Reversible)  
EXT - 1000 x 530 x 190 mm  
BASE UNIT - 600mm  
WASTE - 2 x 90 mm Orbit Strainer included

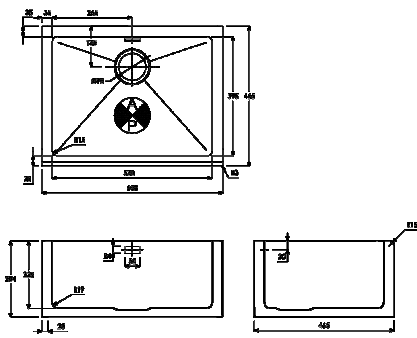

**AW5135**  
BELFAST 1 Bowl Inset sink  
EXT - 600 x 465 x 254 mm  
BASE UNIT - 600mm  
WASTE - 1 x 90 mm Orbit Strainer included

STUDIO STAINLESS STEEL SINK

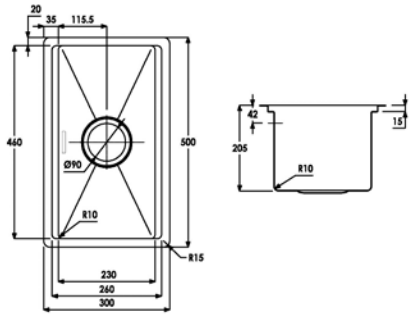

**AW5134**  
STUDIO 1 Bowl preparation sink  
EXT - 500 x 300 x 205 mm  
BASE UNIT - 600mm  
WASTE - 1 x 90 mm Orbit Strainer included  
Comes with 3 Accessories:  
Strainer, Colander and Mini Bowl

# KOHLER STAINLESS STEEL ICEROCK SINGLE BOWL SINKS

## KOHLER Stainless Steel Sinks

KOHLER Stainless Steel Sinks are made from 16 or 18 gauge stainless steel and feature Silent Shield technology which significantly reduces waste disposal noise and helps to maintain temperature.

N.B. All models are now supplied without overflows. Please see below for details of stock held currently with overflows. Only while stocks last. Sinks with overflows would require waste KSC1.

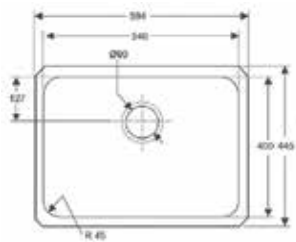

### Icerock

3325-NA

EXT - 584 x 445 x 244 mm  
INT - 540 x 405 x 241 mm

3332-NA £490

EXT - 584 x 445 x 194 mm  
INT - 540 x 405 x 191 mm  
BASE UNIT - 700 mm  
INSTALLATION - Undermount  
WASTE - KSC8

For Kohler taps please see pages 66 - 68

# KOHLER ICEROCK STAINLESS STEEL DOUBLE BOWL SINKS

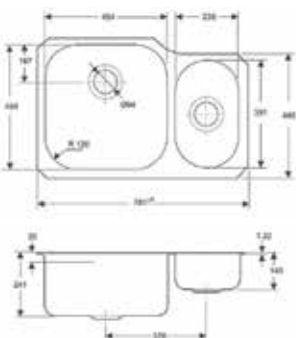

### Icerock

3355-NA

EXT - 781 x 511 x 244 mm  
INT - 454 x 454 x 241 mm  
INT - 235 x 391 x 140 mm  
BASE UNIT - 900 mm  
INSTALLATION - Undermount  
WASTE: KSC8 x 2

# KOHLER STAINLESS STEEL VAULT SINKS

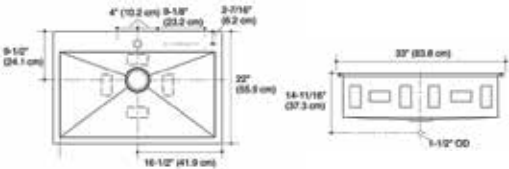

### Vault

3821-1-NA

EXT - 838 x 559 x 237 mm  
INT - 768 x 421 x 229 mm  
BASE UNIT - 900 mm  
INSTALLATION - Inset / Undermount  
WASTE - KSC8  
Includes: Bottom basin rack

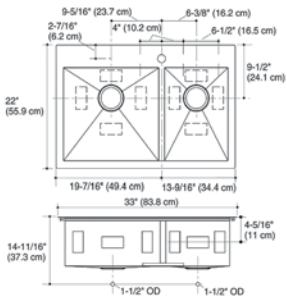

### Vault

3823-1-NA

EXT - 838 x 559 x 237 mm  
INT - 445 x 421 x 229 mm  
INT - 295 x 421 x 229 mm  
BASE UNIT - 900 mm  
INSTALLATION - Inset / Undermount  
WASTE - KSC8 x 2  
Includes: Left bottom basin rack



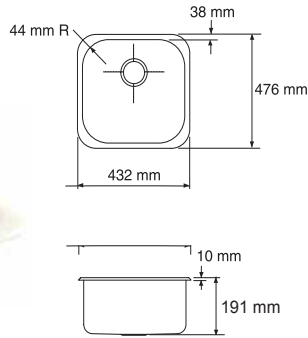

**Iron/Tones**

**6584-0 WHITE**

EXT - 432 x 476 x 201 mm

INT - 356 x 406 x 191 mm

BASE UNIT - 500 mm

INSTALLATION - Inset / Undermount

WASTE - KSC8

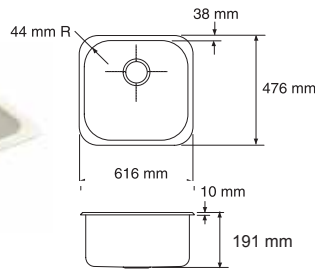

**Iron/Tones**

**6585-0 WHITE**

EXT - 616 x 476 x 201 mm

INT - 533 x 406 x 191 mm

BASE UNIT - 700 mm

INSTALLATION - Inset / Undermount

WASTE - KSC8

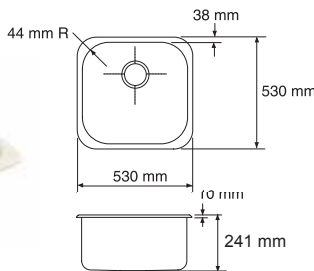

**Iron/Tones**

**6587-0 WHITE**

EXT - 530 x 530 x 254 mm

INT - 457 x 457 x 241 mm

BASE UNIT - 600 mm

INSTALLATION - Inset / Undermount

WASTE - KSC8

Replacement Kohler accessories available - please see website

For the full range of accessories please see [www.kitchensinkco.com](http://www.kitchensinkco.com) or separate Kohler brochure

**SPONGE CADDY**



**6377-0**

**8 DEGREE**



**6133-ST**



**6134-ST**



**6137-ST**

**ICEROCK / IRONTONES**



**6391-ST**

**PAPER TOWEL HOLDER**



**8618 - White or Charcoal**

**SOAP DISPENSER**



**6383 - White or Charcoal**

**DEERFIELD**



**6624-NA**



**1056368 STAINLESS  
STEEL**

While Stocks Last

**BRUSH CADDY**



**6378**

**SURFACE WIPER**



**6379**

**ICEROCK / IRONTONES**



**5137-ST SMART  
DIVIDE**



**5139-ST SMART  
DIVIDE**



**3192-ST**



**6390-ST**

**POISE**

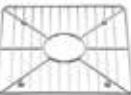

**3142-ST**

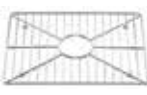

**3143-ST**

**UNDERMOUNT KIT**



**5807**



**6636-NA**

**VERITY**



**3133-ST**

While Stocks Last

**WHITEHAVEN**



**6638-ST**

While Stocks Last

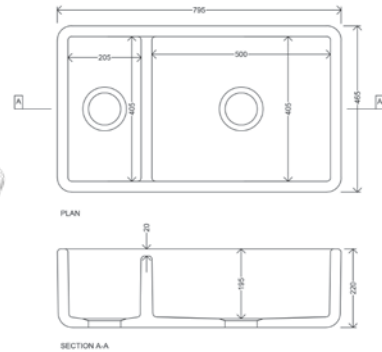

LAN1.5WH  
EXT - 795 x 465 x 220 mm  
WASTE - KSC7 x 2

Due to the firing process, Ceramic Sink dimensions may vary by +/- 2% to 3%.  
Please do take this into account when making bespoke furniture.

LANSDOWNE ACCESSORIES



Oakboard  
370 x 355mm  
OAKBOARD

Draining Board - Glenside Sink



ZV/GLEN/D



ZV/GLEN/L



Protector Rack  
ZV/RACK

320 x 270mm

Protector mats



Small mat 310 x 270mm  
ZV/PMS



Glenside mat 340 x 305mm  
ZV/GLEN/MAT



Micromat 400 x 450mm  
ZV/MICROMAT

Lansdowne Wastes



90mm basket  
strainer waste  
ZV/BSW/BC

60mm basket  
strainer waste  
ZV/BSW/60/PC  
ZV/BSW/60/BC

Lansdowne plumbing kit

Single bowl spacesaving plumbing kit  
ZV/PLUMBKIT/1



ASTRIS (17X40) 1B UM

101027501  
Outer Dimensions - 210 x 440mm  
Bowl Dimensions - 170 x 400 x 170mm  
Minimum Base Unit - 300 mm  
Installation - Undermount  
Brushed finish  
Waste Valve Included - 92mm Diameter



ASTRIS (34X40) 1B UM

101027601  
Outer Dimensions - 380 x 440mm  
Bowl Dimensions - 340 x 400 x 200mm  
Minimum Base Unit - 400 mm  
Installation - Undermount  
Brushed finish  
Waste Valve Included - 92mm Diameter



ASTRIS (40X40) 1B UM

101027701  
Outer Dimensions - 440 x 440mm  
Bowl Dimensions - 400 x 400 x 200mm  
Minimum Base Unit - 450 mm  
Installation - Undermount  
Brushed finish  
Waste Valve Included - 92mm Diameter



ASTRIS (45X40) 1B UM

101027801  
Outer Dimensions - 490 x 440mm  
Bowl Dimensions - 450 x 400 x 200mm  
Minimum Base Unit - 500 mm  
Installation - Undermount  
Brushed finish  
Waste Valve Included - 92mm Diameter





**ASTRIS (50X40) 1B UM**

101027901

Outer Dimensions - 540 x 440mm

Bowl Dimensions - 500 x 400 x 200mm

Minimum Base Unit - 600 mm

Installation - Undermount

Brushed finish

Waste Valve Included - 92mm Diameter



**ASTRIS (74X40) 1B UM**

101028001

Outer Dimensions - 780 x 440mm

Bowl Dimensions - 740 x 400 x 200mm

Minimum Base Unit - 800 mm

Installation - Undermount

Brushed finish

Waste Valve Included - 92mm Diameter



**ASTRIS (57.5X44) 1½B UM**

101030801 Left

101030701 Right

Outer Dimensions - 575 x 440mm

Bowl Dimensions - 340 x 400 x 200mm / 170 x 400 x 170mm

Minimum Base Unit - 600 mm

Installation - Undermount

Brushed finish

Plumbing Kit & Waste Valve Included - 92mm Diameter



**ASTRIS (74.5X44) 2B UM**

101030901

Outer Dimensions - 745 x 440mm

Bowl Dimensions - 340 x 400 x 200mm / 340 x 400 x 200mm

Minimum Base Unit - 800 mm

Installation - Undermount

Brushed finish

Plumbing Kit & Waste Valve Included - 92mm Diameter



**ASTRIS (86.5X44) 2B UM**

101031001

Outer Dimensions - 865 x 440mm

Bowl Dimensions - 400 x 400 x 200mm / 400 x 400 x 200mm

Minimum Base Unit - 900 mm

Installation - Undermount

Brushed finish

Plumbing Kit & Waste Valve Included - 92mm Diameter



**ASTRIS LOW DIVIDER (58X44) 1½B UM**

101056101 Left

101054401 Right

Outer Dimensions - 582 x 440mm

Bowl Dimensions - 340 x 400 x 170mm / 200 x 400 x 170mm

Minimum Base Unit - 600 mm

Installation - Undermount

Brushed finish

Plumbing Kit & Waste Valve Included - 92mm Diameter



LOW DIVIDE BOWL



**ASTRIS LOW DIVIDER (76X44) 2B UM**

101054601

Outer Dimensions - 762 x 440mm

Bowl Dimensions - 360 x 400 x 170mm / 360 x 400 x 170mm

Minimum Base Unit - 800 mm

Installation - Undermount

Brushed finish

Plumbing Kit & Waste Valve Included - 92mm Diameter



LOW DIVIDE BOWL

PYRAMIS GUN METAL SINKS



**ASTRIS COLORA (40X40) 1B UM  
GUN METAL**

101054901

Outer Dimensions - 440 x 440mm

Bowl Dimensions - 400 x 400 x 200mm

Minimum Base Unit - 450 mm

Installation - Undermount

Gun Metal finish

Waste Valve Included - 92mm Diameter







**ASTRIS COLORA (50X40) 1B UM  
GUN METAL**

101055501

Outer Dimensions - 540 x 440mm  
Bowl Dimensions - 500 x 400 x 200mm  
Minimum Base Unit - 600 mm  
Installation - Undermount  
Gun Metal finish  
Waste Valve Included - 92mm Diameter

PYRAMIS COPPER SINKS



**ASTRIS COLORA (40X40) 1B UM COPPER**

101055001

Outer Dimensions - 440 x 440mm  
Bowl Dimensions - 400 x 400 x 200mm  
Minimum Base Unit - 450 mm  
Installation - Undermount  
Copper finish  
Waste Valve Included - 92mm Diameter



**ASTRIS COLORA (50X40) 1B UM COPPER**

101055601

Outer Dimensions - 540 x 440mm  
Bowl Dimensions - 500 x 400 x 200mm  
Minimum Base Unit - 600 mm  
Installation - Undermount  
Copper finish  
Waste Valve Included - 92mm Diameter

PYRAMIS POLISHED STAINLESS STEEL SINKS



**RELIA (33X40) 1B UM**

100012629

Outer Dimensions - 355.5 x 424mm  
Bowl Dimensions - 331.5 x 400 x 180mm  
Minimum Base Unit - 400 mm  
Installation - Undermount  
Polished finish  
Waste Valve Included - 92mm Diameter



**RELIA (40X40) 1B UM**

101053529

Outer Dimensions - 424 x 424mm  
Bowl Dimensions - 400 x 400 x 190mm  
Minimum Base Unit - 450 mm  
Installation - Undermount  
Polished finish  
Waste Valve Included - 92mm Diameter



**RELIA (50X40) 1B UM**

100012329

Outer Dimensions - 524 x 424mm  
Bowl Dimensions - 500 x 400 x 180mm  
Minimum Base Unit - 600 mm  
Installation - Undermount  
Polished finish  
Waste Valve Included - 92mm Diameter



**RELIA (57X45) 1½B**

109402630 Left

109402530 Right

Outer Dimensions - 573 x 450mm  
Bowl Dimensions - 331.5 x 400 x 180mm /  
161.5 x 400 x 120mm  
Minimum Base Unit - 600 mm  
Installation - Undermount  
Polished finish  
Plumbing Kit & Waste Valve Included - 92mm Diameter



**RELIA (91X45) 2B**

109402930

Outer Dimensions - 911.5 x 450mm  
Bowl Dimensions - 500 x 400 x 180mm/  
331.5 x 400 x 180mm  
Minimum Base Unit - 900 mm  
Installation - Undermount  
Polished finish  
Reversible  
Plumbing Kit & Waste Valve Included - 92mm Diameter





**ZERIA (56X45) 1B**

108983401

Sink Dimensions - 560 x 520mm  
Bowl Dimensions - 500 x 400 x 180mm  
Minimum Base Unit - 600 mm  
Installation - Inset & Flushmount  
Polished finish  
Plumbing Kit & Waste Valve Included - 92mm Diameter



**ZERIA (58X52) 1 1/2B**

108983701 Left

108983501 Right

Sink Dimensions - 580 x 520mm  
Bowl Dimensions - 331.5 x 400 x 180mm /  
161.5 x 400 x 120mm  
Minimum Base Unit - 600 mm  
Installation - Inset & Flushmount  
Polished finish  
Plumbing Kit & Waste Valve Included - 92mm Diameter

PYRAMIS BRUSHED STAINLESS STEEL SINKS



**ZERIA (75X52) 2B**

108983601

Sink Dimensions - 750 x 520mm  
Bowl Dimensions - 331.5 x 400 x 180mm /  
331.5 x 400 x 180mm  
Minimum Base Unit - 800 mm  
Installation - Inset & Flushmount  
Brushed finish  
Plumbing Kit & Waste Valve Included - 92mm Diameter



**LYDIA (74X44) 2B**

101046401

Sink Dimensions - 740 x 440 x 200mm  
Bowl Dimensions - 700 x 400 x 180mm  
Minimum Base Unit - 800 mm  
Installation - Undermount  
Brushed finish  
Waste Valve Included - 92mm Diameter



**IRIS (50X40) 1B UM**

100008429

Outer Dimensions - 523 x 424mm  
Bowl Dimensions - 500 x 400 x 200mm  
Minimum Base Unit - 600 mm  
Installation - Undermount  
Polished finish  
Waste Valve Included - 92mm Diameter



**DIONE (59X46) 1 1/2B UM**

109401001

109401301 Right

Outer Dimensions - 590 x 456mm  
Bowl Dimensions - 340 x 400 x 180mm /  
165 x 288 x 120mm  
Minimum Base Unit - 600 mm  
Installation - Undermount  
Polished finish  
Plumbing Kit & Waste Valve Included - 92mm Diameter



PYRAMIS ZEUS WORKSTATION SINKS

**Zeus Stainless Steel Sinks**

Turn your sink into a true workstation. Zeus sinks feature integrated ledges that allow you to slide accessories across the sink, transforming it into a multi-purpose workspace.

**Features:**

- ✓ Available for dual installation either undermount or inset / flushmount.
- ✓ Finish: Scotch Brite.
- ✓ Packaging: Boxed with stainless steel draining board, waste and fixings included.
- ✓ Large selection of optional practical accessories, strainer, colander, chopping board, etc.
- ✓ Large bowl with a bowl depth of 210mm.
- ✓ Made from 1 mm thick stainless steel.

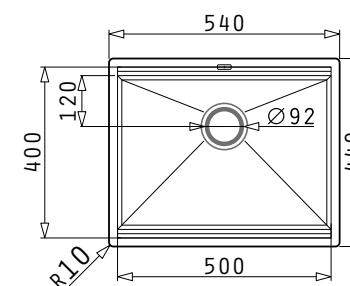

**Zeus 50**

101061801

Bowl Dimensions - 500 x 400 x 200mm  
Installation - Surface Mount  
Scotch Brite finish

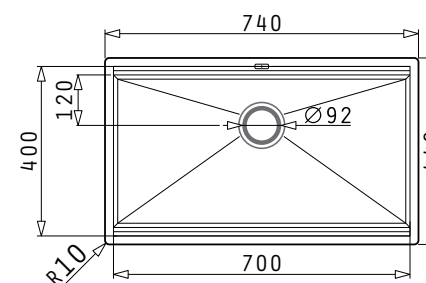

**Zeus 70**

101061901

Bowl Dimensions - 700 x 400 x 200mm  
Installation - Surface Mount  
Scotch Brite finish



Please note the Regis range contains a varied selection of sinks from different manufacturers. Please ask for any further details.  
Wastes not included unless stated. Tap hole drilled on request.

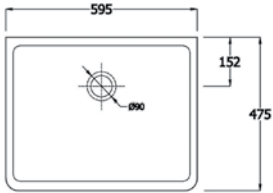

RF0595  
EXT - 595 x 475 x 225 mm  
WASTE - KSC3

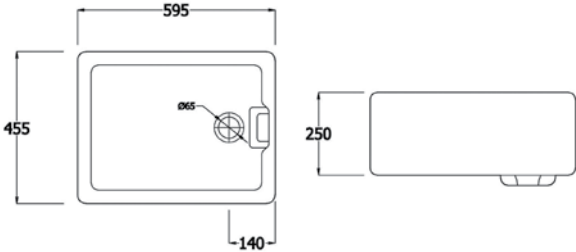

Standard Belfast  
RB0001  
Metric (Domestic Quality)  
EXT - 595 x 455 x 250 mm  
WASTE - KSC6  
(Only available in a Stainless Steel or Non-Tarnish Brass finish)

REGIS DOUBLE BOWL BELFAST & FARMHOUSE SINKS

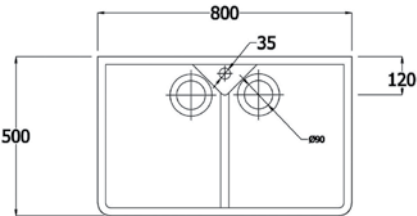

RF0800\*  
EXT - 800 x 500 x 220 mm  
WASTE - KSC7 x 2

Please note the Regis range contains a varied selection of sinks from different manufacturers. Please ask for any further details.  
Wastes not included unless stated. Tap hole drilled on request.

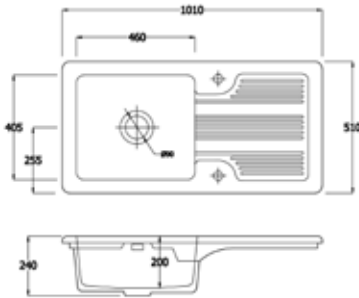

RI0001NS  
Reversible - right or left drainer available  
EXT - 1010 x 510 mm  
BASE UNIT - 600mm  
WASTE - KSC3

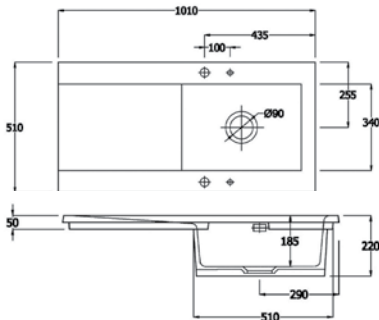

RD1001NS  
Left hand or right drainer  
EXT - 1010 x 510 x 220 mm  
BASE UNIT - 600 mm  
WASTE - KSC3



Please note the Regis range contains a varied selection of sinks from different manufacturers. Please ask for any further details.  
Wastes not included unless stated. Tap hole drilled on request.

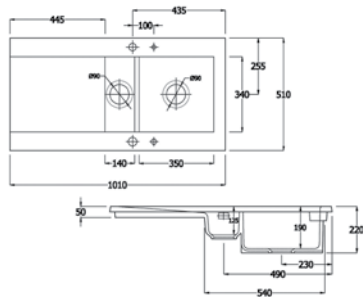

**RD1015NS**  
Reversible  
EXT - 1010 x 510 x 220 mm  
BASE UNIT - 600mm  
WASTE - KSC3 & KSC7

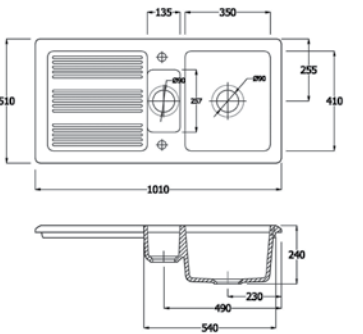

**RI0015NS**  
Reversible  
EXT - 1010 x 510 mm  
BASE UNIT - 600mm  
WASTE - KSC7 x 2

REGIS UNDERMOUNT OR INSET SINKS

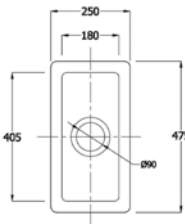

**RU0240**  
EXT - 250 x 475 x 155 mm  
Inset or Undermount  
WASTE - KSC3

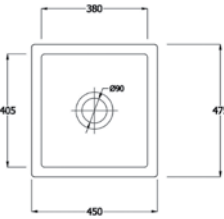

**RU0450**  
Inset or Undermount  
EXT - 450 x 475 x 200 mm  
WASTE - KSC3

Ceramic sink dimensions may vary +/- 2% to 3% due to firing process, please do take this into account when making Bespoke furniture.

Traditional, beautiful and practical, the Original Collection represents our premium offering, designed to provide you with a sink of substance, created to add authenticity, charm and character to your room.

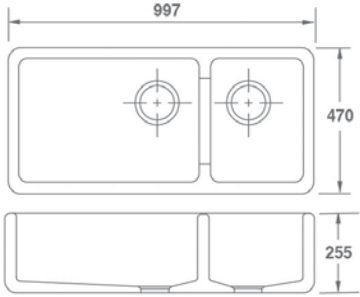

**EDF9917WH**  
EGERTON Double Bowl Sink  
DIMENSIONS - 997 x 470 x 255 mm  
INSTALLATION - Sit on  
WASTE - FT29000  
GRID TYPE 6 - LH BOWL  
GRID TYPE 5 - RH BOWL

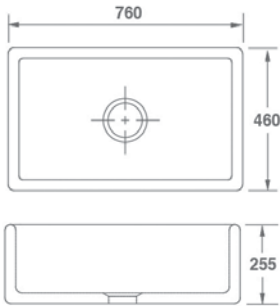

**SOEN800WH**  
ENTWISTLE Single Bowl Sink  
DIMENSIONS - 760 x 460 x 255 mm  
INSTALLATION - Sit on  
WASTE - FT29000  
GRID TYPE 1

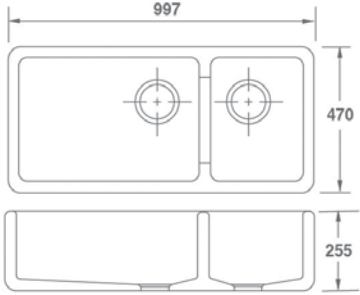

**SEDG100WH**  
EDGORTH Double Bowl Sink  
DIMENSIONS - 997 x 470 x 255 mm  
INSTALLATION - Sit on  
WASTE - FT29000  
GRID TYPE 6 - LH BOWL  
GRID TYPE 5 - RH BOWL

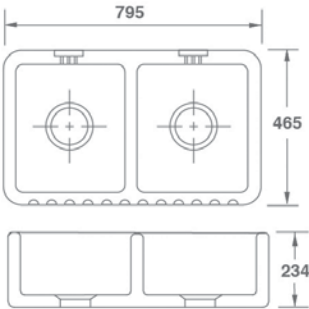

**SO0800010WH**  
RIBCHESTER 800 Double Bowl Sink  
DIMENSIONS - 795 x 465 x 234 mm  
INSTALLATION - Sit on  
WASTE - FT29000  
GRID TYPE 4 - LH & RH BOWL

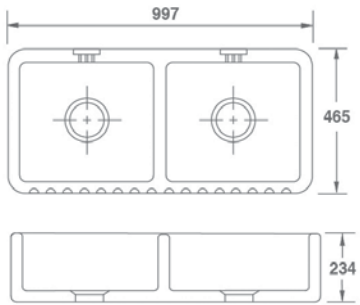

**SO2400010WH**  
RIBCHESTER 1000 Double Bowl Sink  
DIMENSIONS - 997 x 465 x 234 mm  
INSTALLATION - Sit on  
WASTE - FT29000  
GRID TYPE 4 - LH & RH BOWL

Ceramic sink dimensions may vary +/- 2% to 3% due to firing process, please do take this into account when making Bespoke furniture.

## THE ORIGINAL COLLECTION

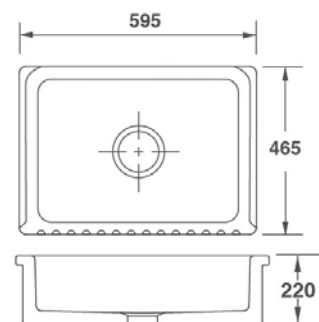

### SO0600010WH

BOWLAND 600 Single Bowl Sink  
DIMENSIONS - 595 x 465 x 220 mm  
INSTALLATION - Sit on  
WASTE - FT29000  
GRID TYPE 3

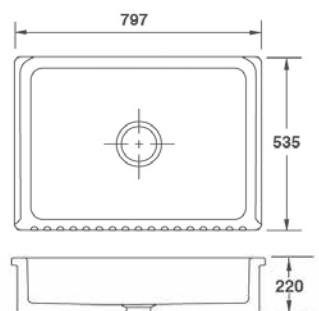

### BLF5312WH

BOWLAND 800 Single Bowl Sink  
DIMENSIONS - 797 x 535 x 220 mm  
INSTALLATION - Sit on  
WASTE - FT29000  
GRID TYPE 1

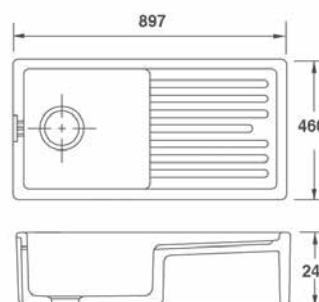

### FCSO0610WH

LONGRIDGE Single Bowl Sink  
DIMENSIONS - 897 x 460 x 240 mm  
INSTALLATION - Sit on  
WASTE - FT29000  
NO GRID AVAILABLE

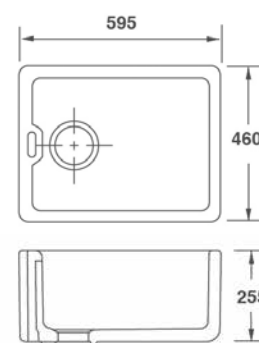

### SO0900010WH

PENNINE Single Bowl Sink  
DIMENSIONS - 595 x 460 x 255 mm  
INSTALLATION - Sit on  
WASTE - FT29000  
GRID TYPE 2

Ceramic sink dimensions may vary +/- 2% to 3% due to firing process, please do take this into account when making Bespoke furniture.

## THE CONTEMPORARY COLLECTION

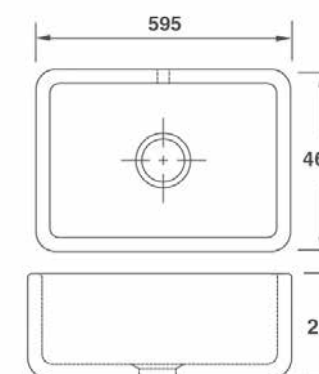

### SCBU600WH

BUTLER 600 Single Bowl Sink  
DIMENSIONS - 595 x 460 x 255 mm  
INSTALLATION - Sit on  
WASTE - FT29000  
GRID TYPE 3

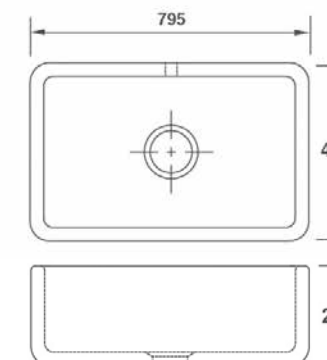

### SCBU800WH

BUTLER 800 Single Bowl Sink  
DIMENSIONS - 795 x 460 x 255 mm  
INSTALLATION - Sit on  
WASTE - FT29000  
GRID TYPE 1

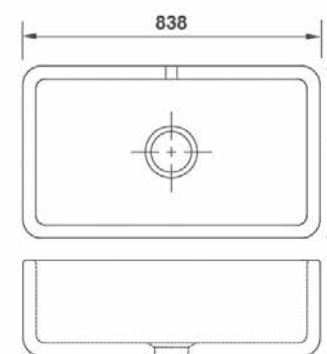

### SCBU900WH

BUTLER 900 Single Bowl Sink  
DIMENSIONS - 838 x 460 x 255 mm  
INSTALLATION - Sit on  
WASTE - FT29000  
NO GRID AVAILABLE

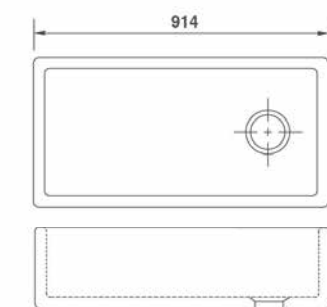

### SCBU101WH

BUTLER 1000 Single Bowl Sink  
DIMENSIONS - 914 x 460 x 255mm  
INSTALLATION - Sit on  
WASTE - FT29000  
NO GRID AVAILABLE

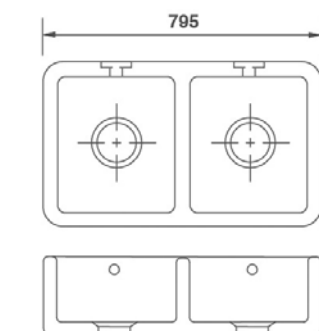

### SCLD800WH

DOUBLE BOWL 800  
DIMENSIONS - 795 x 465 x 229mm  
INSTALLATION - Sit on  
WASTE - FT29000  
GRID TYPE 4 - LH & RH BOWL

Ceramic sink dimensions may vary +/- 2% to 3% due to firing process, please do take this into account when making Bespoke furniture.

## THE CONTEMPORARY COLLECTION

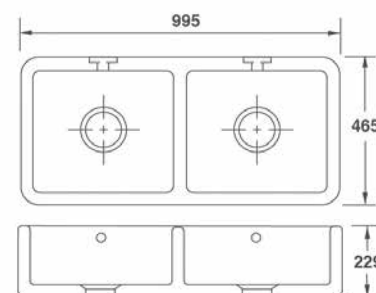

**SCLD101WH**  
DOUBLE BOWL 1000  
DIMENSIONS - 995 x 465 x 229mm  
INSTALLATION - Sit on  
WASTE - KSC9SS or FT29000  
GRID TYPE 4 - LH & RH BOWL

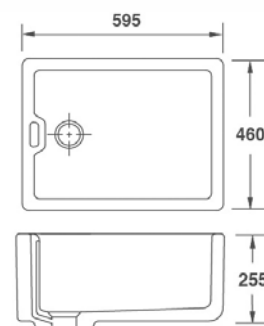

**SCPE595WH**  
PENDLE Single Bowl Sink  
DIMENSIONS - 595 x 460 x 255 mm  
INSTALLATION - Sit on  
WASTE - KSC6 or FT21000  
GRID TYPE 2

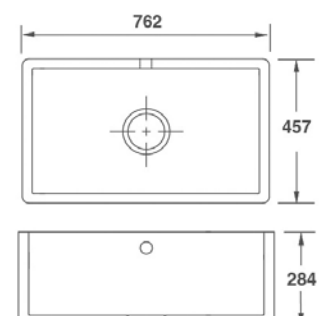

**SCSH108WH**  
SHAKER SINGLE  
DIMENSIONS - 762 x 457 x 284 mm  
INSTALLATION - Sit on  
WASTE - KSC9SS or FT29000  
GRID TYPE 1

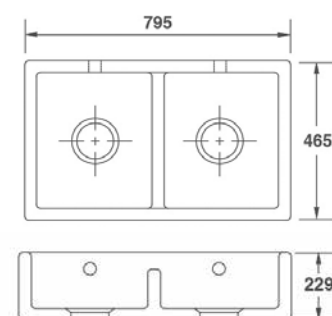

**SCSH800WH**  
SHAKER DOUBLE 800  
DIMENSIONS - 795 x 465 x 229 mm  
INSTALLATION - Sit on  
WASTE - KSC9SS or FT29000  
GRID TYPE 4 - LH & RH BOWL

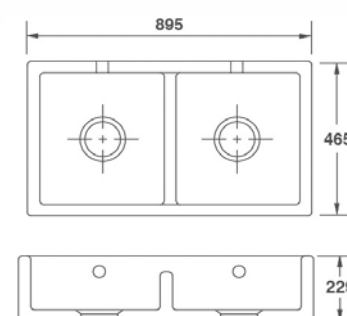

**SCSH900WH**  
SHAKER DOUBLE 900  
DIMENSIONS - 895 x 465 x 229 mm  
INSTALLATION - Sit on  
WASTE - KSC9SS or FT29000  
GRID TYPE 4 - LH & RH BOWL

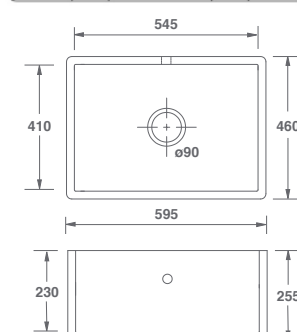

**SCSH600WH**  
SHAKER Single Bowl Sink  
DIMENSIONS - 595 x 460 x 255 mm  
INSTALLATION - Sit On  
WASTE - KSC9SS or FT29000

Ceramic sink dimensions may vary +/- 2% to 3% due to firing process, please do take this into account when making Bespoke furniture.

## THE CONTEMPORARY COLLECTION

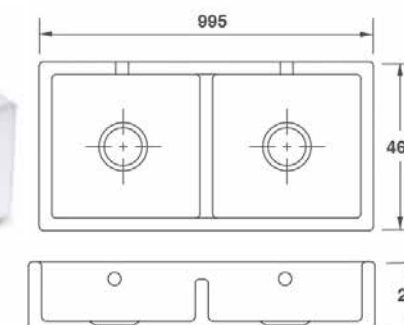

**SCSH101WH**  
SHAKER DOUBLE 1000  
DIMENSIONS - 995 x 465 x 229 mm  
INSTALLATION - Sit on  
WASTE - KSC9SS or FT29000  
GRID TYPE 4 - LH & RH BOWL

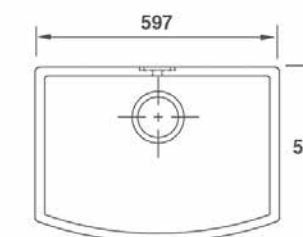

**SCWT595WH**  
WATERSIDE 600 Single Bowl Sink  
DIMENSIONS - 597 x 530 x 220 mm  
INSTALLATION - Sit on  
WASTE - KSC9SS or FT29000  
GRID TYPE 7

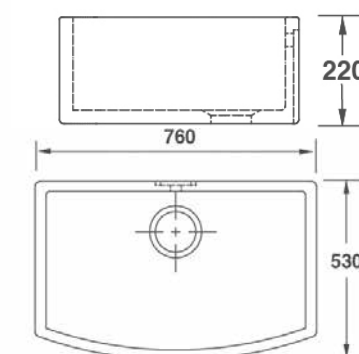

**SCWT760WH**  
WATERSIDE 800 Single Bowl Sink  
DIMENSIONS - 760 x 530 x 255 mm  
INSTALLATION - Sit on  
WASTE - KSC9SS or FT29000  
GRID TYPE 8

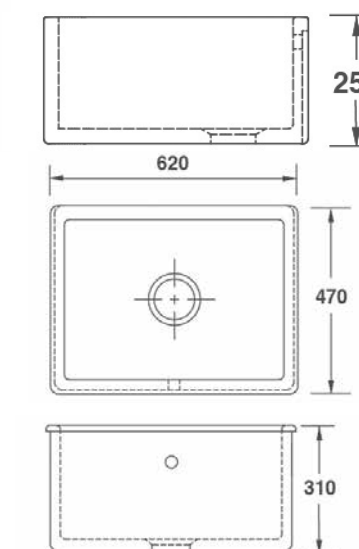

**SCWH600WH**  
WHITEHALL Single Bowl Sink  
DIMENSIONS - 620 x 470 x 310 mm  
INSTALLATION - Sit on  
WASTE - KSC9SS or FT29000  
NO GRID AVAILABLE

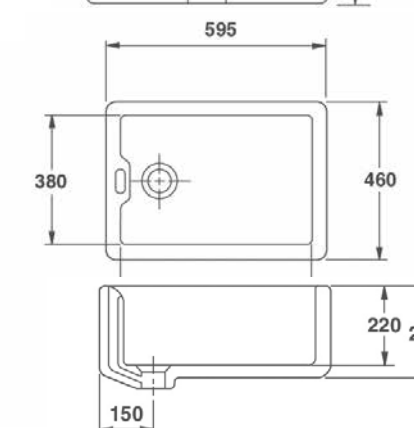

**SCBE600WH**  
BELFAST Single Bowl Sink  
DIMENSIONS - 595 x 460 x 255 mm  
INSTALLATION - Sit on  
WASTE - KSC6 or FT21000  
GRID TYPE 2

Ceramic sink dimensions may vary +/- 2% to 3% due to firing process, please do take this into account when making Bespoke furniture.



## THE INSET & UNDERMOUNT COLLECTION

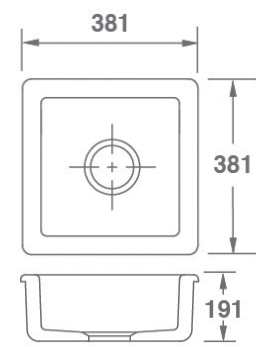

**SBEL381WH**  
BELTHORN Single Bowl Sink  
DIMENSIONS - 381 x 381 x 191 mm  
INSTALLATION - Inset or Undermount  
WASTE - KSC9SS or FT29000  
NO GRID AVAILABLE

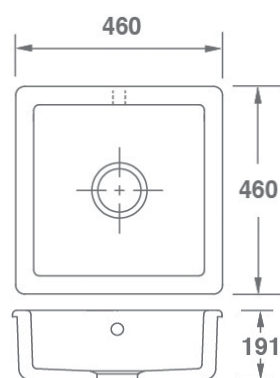

**SCSQ460WH**  
SQUARE Single Bowl Sink  
DIMENSIONS - 460 x 460 x 191 mm  
INSTALLATION - Inset or Undermount  
WASTE - KSC9SS or FT29000  
GRID TYPE 4

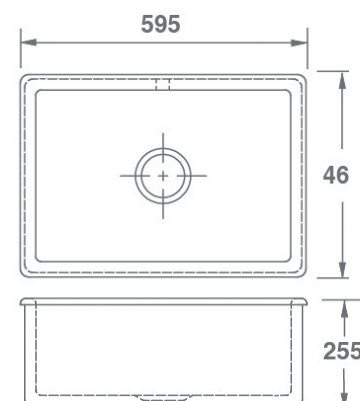

**SCIN595WH**  
INSET 600 Single Bowl Sink  
DIMENSIONS - 595 x 460 x 255 mm  
INSTALLATION - Inset or Undermount  
WASTE - KSC9SS or FT29000  
GRID TYPE 3

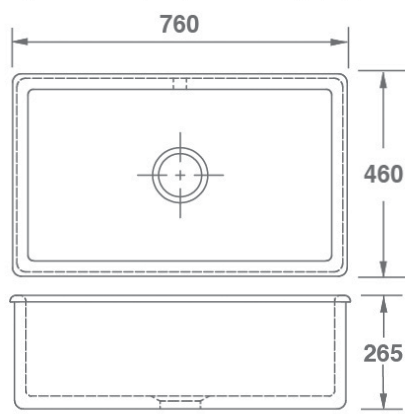

**SCIN760WH**  
INSET 800 Single Bowl Sink  
DIMENSIONS - 760 x 460 x 265 mm  
INSTALLATION - Inset or Undermount  
WASTE - KSC9SS or FT29000  
GRID TYPE 1

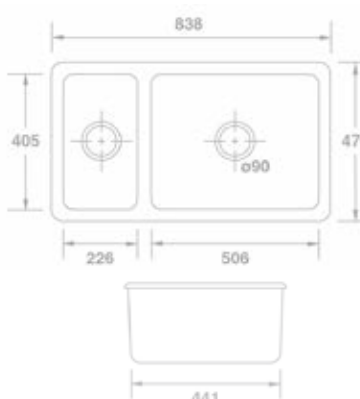

**SCBR900WH**  
BRADSHAW  
1.5 Bowl Sink  
DIMENSIONS - 838 x 476 x 244 mm  
INSTALLATION - Inset or Undermount?  
WASTE - KSC9SS or FT29000  
NO GRID AVAILABLE

Ceramic sink dimensions may vary +/- 2% to 3% due to firing process, please do take this into account when making Bespoke furniture.

## THE INSET & UNDERMOUNT COLLECTION

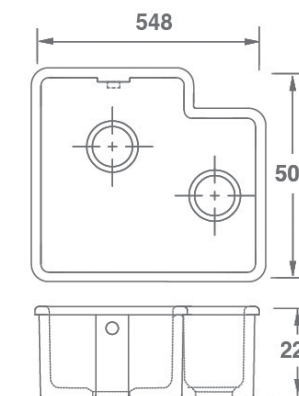

**SCBH595WH**  
BRINDLE 600  
DIMENSIONS - 548 x 500 x 225 mm  
INSTALLATION - Inset or Undermount  
WASTE - KSC9SS or FT29000  
NO GRID AVAILABLE

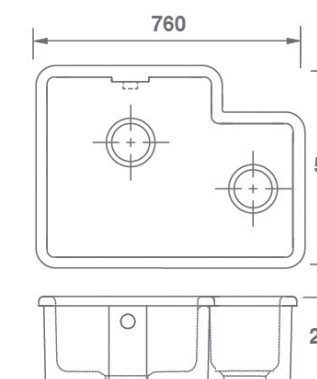

**SCBH760WH**  
BRINDLE 800  
DIMENSIONS - 760 x 500 x 225 mm  
INSTALLATION - Inset or Undermount  
WASTE - KSC9SS or FT29000  
NO GRID AVAILABLE

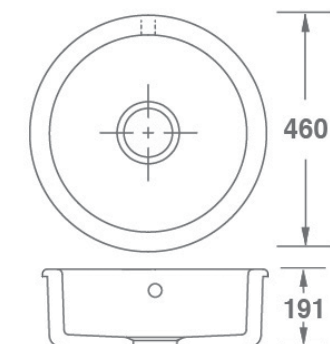

**SCRO460WH**  
ROUND Single Bowl Sink  
DIMENSIONS - 460 Diameter x 191 mm  
INSTALLATION - Inset or Undermount  
WASTE - KSC9SS or FT29000  
NO GRID AVAILABLE

## PROFESSIONAL COLLECTION



Traditional heavy duty fireclay sink, with built-in top edge.

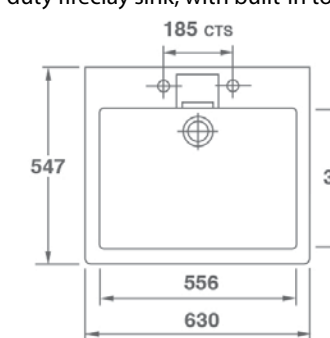

**SH0100010**  
SHELF Single Bowl Sink  
DIMENSIONS - 630 x 547 x 255 mm  
BASE UNIT - 700mm  
WASTE - FT2100011 Chrome or  
FT2100012 Gold 1½"



Please check availability before ordering

Ceramic sink dimensions may vary +/- 2% to 3% due to firing process, please do take this into account when making Bespoke furniture.

## PROFESSIONAL COLLECTION

Traditional heavy duty fireclay Belfast sink with centre end waste outlet & weir overflow. Available in 7 sizes.

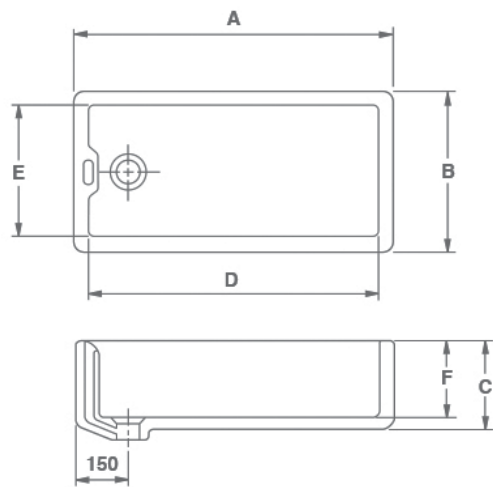

### BS0100010 18"

BELFAST Single Bowl Sink  
DIMENSIONS - A:460 B:380 C:205 D:390 E:310 F:165  
BASE UNIT - 500 mm  
WASTE - FT2100011 Chrome or FT2100012 Gold 1½"

### BS0700010 36"

BELFAST Single Bowl Sink  
DIMENSIONS - A:895 B:460 C:245 D:840 E:380 F:220  
BASE UNIT - 1000 mm  
WASTE - FT2100011 Chrome or FT2100012 Gold 1½"

### BS0600010 30"

BELFAST Single Bowl Sink  
DIMENSIONS - A:795 B:460 C:245 D:690 E:380 F:220  
BASE UNIT - 800 mm  
WASTE - FT2100011 Chrome or FT2100012 Gold 1½"

### BS0800010 METRIC

BELFAST Single Bowl Sink  
DIMENSIONS - A:595 B:460 C:245 D:540 E:380 F:220  
BASE UNIT - 600 mm  
WASTE - FT2100011 Chrome or FT2100012 Gold 1½"

## ACCESSORIES

### BASKET STRAINERS 3½"

- FT2900013 CHROME
- FT2900030 GOLD
- FT2900029 NICKEL
- FT2900028 ANTIQUE BRONZE

### BASKET STRAINERS 1½"

- FT2100011 CHROME
- FT2100012 GOLD

### SLOTTED WASTE CHROME

- FT2100013 CHROME



### BOTTOM RACKS (GRIDS)

- FT01 00010 GRID TYPE 1
- FT02 00010 GRID TYPE 2
- FT03 00010 GRID TYPE 3
- FT04 00010 GRID TYPE 4
- FT05 00010 GRID TYPE 5
- FT06 00010 GRID TYPE 6
- FT07 00010 GRID TYPE 7
- FT08 00010 GRID TYPE 8
- FT09 00010 GRID TYPE 9



## SPECIAL OFFERS

SAVE 10% or MORE

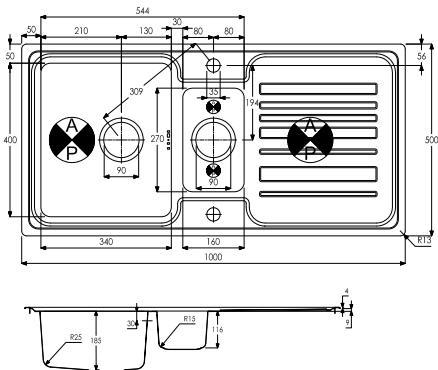

### Apex Stainless Steel Inset Sink AW5048

APEX 1.5 Bowl & Drainer (Reversible)  
EXT - 1000 x 500 x 196 mm  
BASE UNIT - 600 mm  
WASTE - 90 mm Orbit Strainer included  
ACCESSORIES - AX2013, AX2501, AX3011, AX2502, AX2503

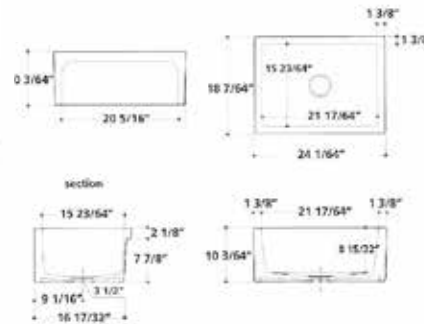

### RB0610

EXT - 610 x 460 x 254 mm  
WASTE - KSC7  
REVERSIBLE  
While Stocks Last

Wastes and Plumbing Kit not included unless stated. \*Accessories not included.  
While Stocks Last.

Ceramic sink dimensions may vary +/- 2% to 3% due to firing process, please do take this into account when making Bespoke furniture.

## LANSDOWNE TAPS

LANSDOWNE

### Rochelle Monobloc

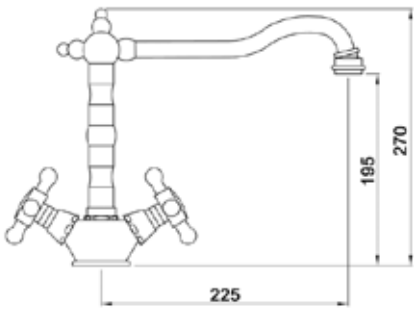

ZV/ROCH/MONO/PC

### Rochelle Bridge Capstan

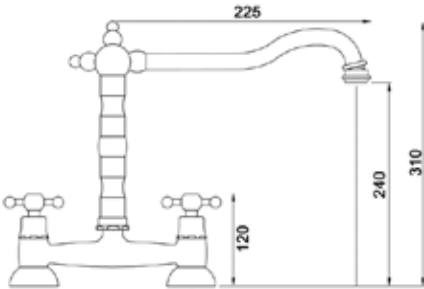

ZV/ROCH/BR/PB

Ceramic sink dimensions may vary +/- 2% to 3% due to firing process, please do take this into account when making Bespoke furniture.

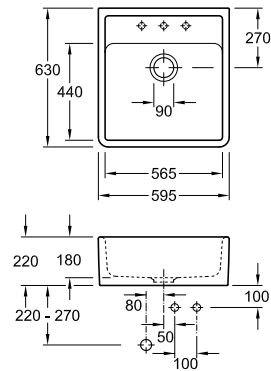

**Butler 60**  
**6320 00R1**  
 EXT – 595 x 630 x 220mm  
 3 Semi punched holes for tap fitting  
 Base Unit 600mm  
 Waste required – KSC1

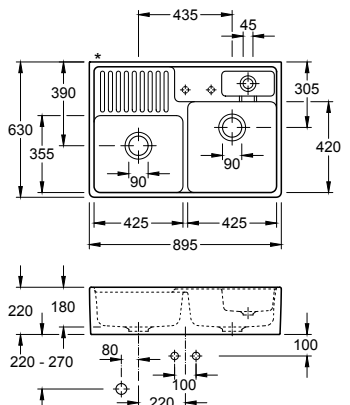

**Butler 90**  
**6323 91R1**  
 EXT – 895 x 630 x 220mm  
 2 Semi punched holes for tap fitting  
 Base Unit 900mm  
 Includes strainer bowl, transparent, waste system basket strainer & fastening set

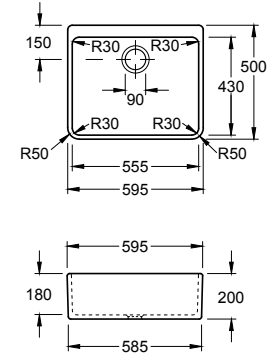

**Farmhouse 60**  
**6322 9501**  
 EXT – 600 x 500 x 200mm  
 Waste required – KSC1  
 Base Unit 600mm

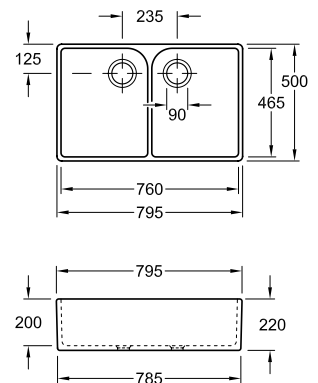

**Farmhouse 80**  
**6331 9501**  
 EXT – 795 x 500 x 220mm  
 Waste required – KSC1 x 2  
 Base Unit 800mm

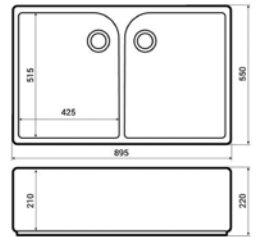

**Farmhouse 90**  
 (previously RF4097)  
**6332 9501**  
 Ext – 895 X 550 X 220mm  
 Waste required – KSC1 x 2  
 Base Unit 900mm

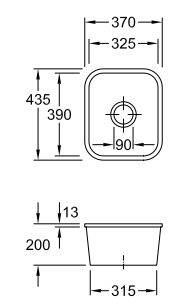

**Cisterna 45**  
**6704 0001**  
 Ext – 370 x 435 x 200mm  
 Waste required – KSC1  
 Base Unit 450mm

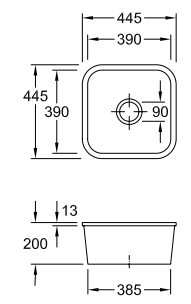

**Cisterna 50**  
**6703 0001**  
 Ext – 445 x 445 x 200mm  
 Waste required – KSC1  
 Base Unit 500mm

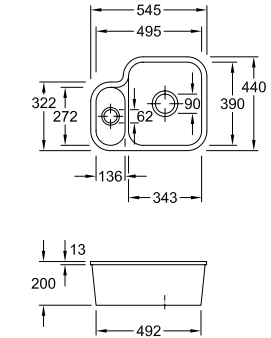

**Cisterna 60B**  
**6702 0101**  
 Ext – 545 x 440 x 200mm  
 Includes waste system basket strainer, strainer bowl, transparent & fastening set  
 Base Unit 600mm

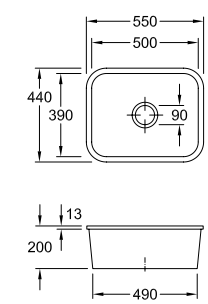

**Cisterna 60C**  
**6706 0001**  
 Ext – 550 x 440 x 200mm  
 Waste required – KSC1  
 Base Unit 600mm

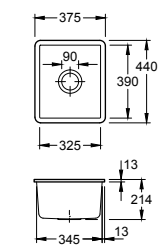

**Subway 45SU**  
**3324 00R1**  
 Ext – 375 x 440 x 214mm  
 Waste required – KSC1  
 Base Unit 400mm



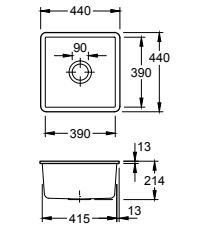

Subway 50SU

3325 00R1  
Ext – 440 x 440 x 214mm  
Waste required – KSC1  
Base Unit 500mm

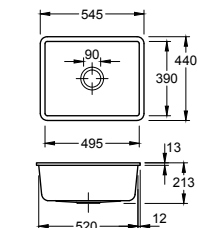

Subway 60SU

3310 00R1  
Ext – 545 x 440 x 213mm  
Waste required – KSC1  
Base Unit 600mm

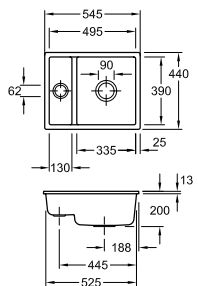

Subway 60XU

6758 01R1  
Ext – 545 x 440 x 200mm  
Includes waste system basket  
strainer  
Base Unit 600mm

VILLEROY & BOCH SIT ON SINKS

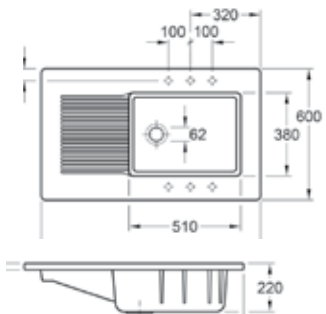

6738 0301  
EXT - 1000 x 600 x 220 mm  
BASE UNIT - 1000 mm  
WASTE - Supplied with waste  
& Overflow

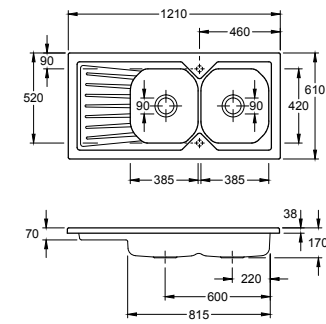

3390 0101  
Ext – 1210 x 610mm  
Base Unit - 900 mm  
Waste & overflow supplied

Althia  
Single Lever  
Min 0.75 bar  
pressure



CP AT1258



BN AT1259



GR AT1269



MB AT1270



UC AT1272

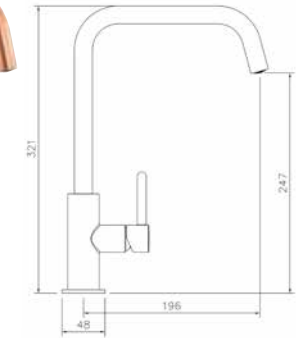

Althia  
Single Lever  
Min 0.75 bar  
pressure



BB AT2103

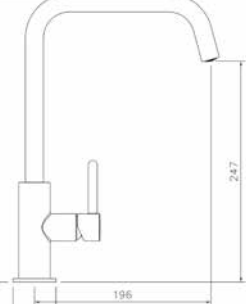

Althia  
Pull Out  
Min 1.0 bar  
pressure



CP AT1260



BN AT1261

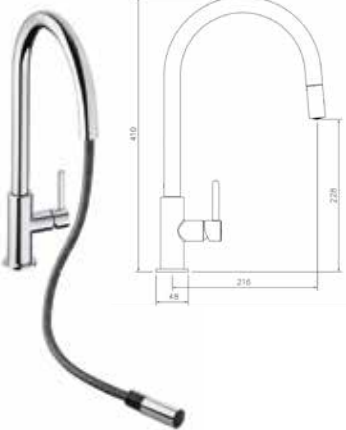

Althia  
Monobloc  
Min 0.3 bar  
pressure



CP AT1256



BN AT1257

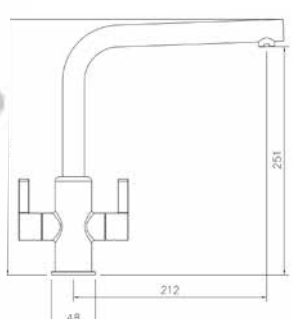

CP AT1156



BN AT1157

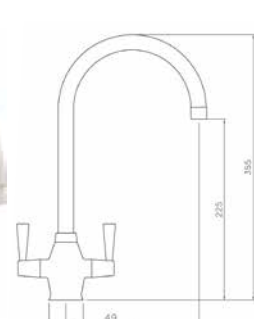

Astral  
Min 0.3 bar  
pressure



CP AT1156



BN AT1157

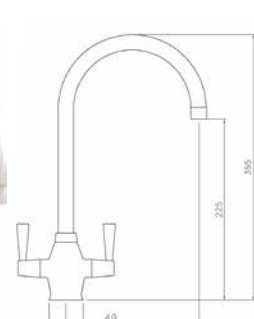

Agilis  
Min 0.75 bar pressure



AT2184



AT2185



AT2186



AT2187



AT2188

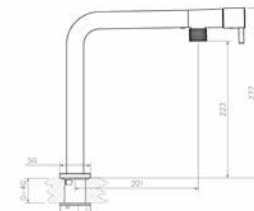

Material Key

CP: Chrome Plate • BN: Brushed Nickel • AN: Antique Nickel • GB: Granite Black • GW: Gloss White • MB: Matt Black • EG: English Gold • BB: Brushed Brass  
FB: Forged Brass • AB: Antique Bronze • SS: Stainless Steel • PW: Pewter • RG: Rose Gold • UC: Urban Copper • CC: Century Copper • GR: Graphite

Atik  
Min 0.4 bar pressure



Atlas  
Min 0.2 bar pressure



Atlas  
Min 0.2 bar pressure



Atlas Single Lever  
Min 0.5 bar pressure



Atlas Professional Monobloc  
Min 0.75 bar pressure



NEW Atlas Quad  
Min 0.20 / 5.5 bar pressure



Atlas Professional Single Lever  
Min 0.8 bar pressure



Ophelia Pull Out  
Min 0.8 bar pressure



Coniq S Single Lever  
Min 0.9 bar pressure

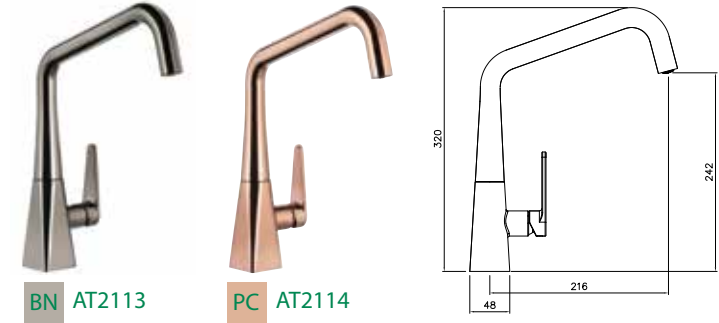

Coniq R Single Lever  
Min 0.8 bar pressure

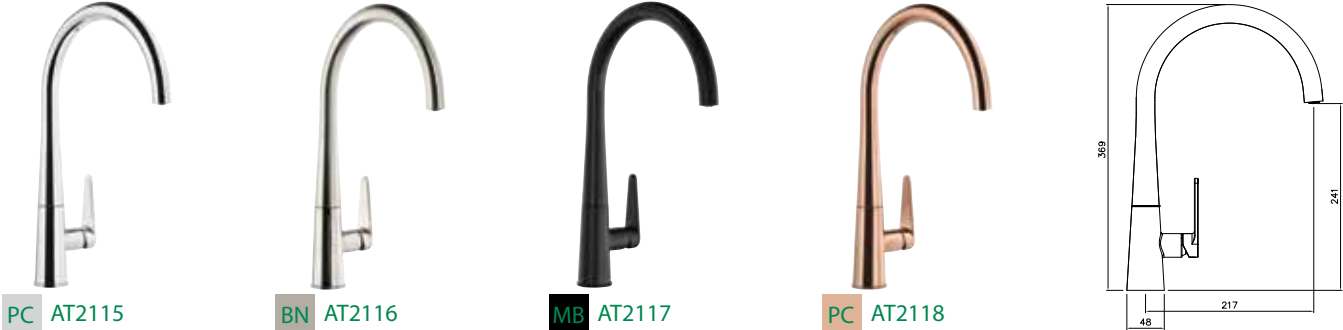

Coniq R Single Lever Pull Out  
Min 1.0 bar pressure



Coniq R Monobloc  
Min 0.5 bar pressure



Czar Single Lever Pull Out  
Min 0.9 bar pressure



CP AT1240

Czar Single Lever  
Min 0.9 bar pressure



CP AT1241

Fluid  
Min 0.4 bar pressure



CP AT1169

BN AT1170

Fraction Single Lever  
Min 0.5 bar pressure



MB AT2155

CP AT2152

BN AT2153

AB AT2154

Fraction Single Lever pull-out spray  
Min 1.5 bar pressure



CP AT2156

BN AT2157

AB AT2158

MB AT2159

Fraction - Semi Professional  
Min 1.5 bar pressure



CP AT2160

BN AT2161

Genio  
Min 0.4 bar pressure



CP AT2071

Genio Semi Professional Pull Around

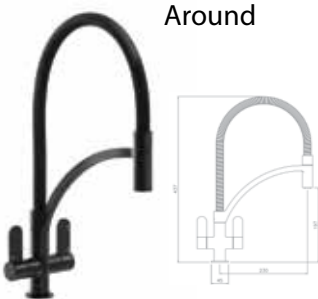

MB AT2183

Globe Single Lever  
Min 0.5 bar pressure



CP AT2146

BN AT2147

BB AT2148

MB AT2149

Globe Quad  
Min 0.5 bar pressure



CP AT2142

BN AT2143

BB AT2144

MB AT2145

Globe Monobloc Twin Levers  
Min 0.5 bar pressure



CP AT2138

BN AT2139

BB AT2140

MB AT2141

Globe Professional  
Min 0.5 bar pressure



CP AT2150

BN AT2151

Hesta (pull out)  
Min 0.75 bar pressure



CP AT1205

BN AT1206

Hex Single Lever  
Min 0.85 bar pressure



BN AT2085

Hex Single Lever  
Min 0.85 bar pressure



MB AT2086

Hex Single Lever  
Min 0.85 bar pressure



AB AT2087

Hex Single Lever with a pull-out spray nozzle  
Min 1.25 bar pressure



BN AT2088

MB AT2089

AB AT2090

Hex Dual Lever  
Min 0.5 bar pressure



BN AT2091

MB AT2092

AB AT2179

Hex Single Lever  
Min 0.5 bar pressure



AB AT2180

Hex Single Lever with a pull-out spray  
Min 0.5 bar pressure



AB MB AT2181



Hex Dual Lever  
Min 0.5 bar pressure



AB AT2093

Hex Professional  
Min 0.5 bar pressure



MB BN AT2094

Hex Pull Out  
Min 0.5 bar pressure



AB AT2199

Hex Pull Out  
Min 0.5 bar pressure



BN AT2198

Linear Flair  
Min 0.5 bar pressure



CP AT1220

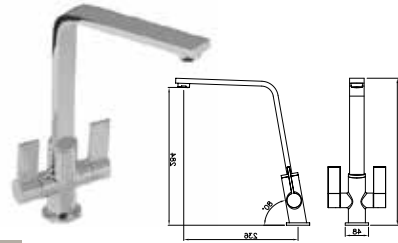

BN AT1221

Hydrus  
Min 0.5 bar pressure



CP AT1088



BN AT1089

Linear Nero  
Min 0.5 bar pressure



CP AT1184

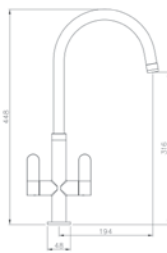

New Media  
Min 0.5 bar pressure



CP AT1180



BN AT1181



GB AT1182

Nexa  
Min 0.3 bar pressure



CP AT1222

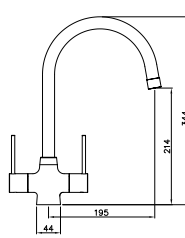

BN AT1223

Material Key

PC: Polished Chrome • BN: Brushed Nickel • AN: Antique Nickel • GB: Granite Black • GW: Gloss White • MB: Matt Black • EG: English Gold • BB: Brushed Brass  
FB: Forged Brass • AB: Antique Bronze • SS: Stainless Steel • PW: Pewter • RG: Rose Gold • PC: Polished Copper • CC: Century Copper • GR: Graphite

Pico Monobloc  
Min 0.5 bar pressure



CP AT1226



BN AT1227



MB AT2095



BB AT2045

Pico Quad  
Min 0.4 bar pressure



PC AT2134



MB AT2137



BN AT2135



BB AT2136

Prime Single Lever  
Min 0.5 bar pressure



CP AT1254



BN AT1255



MB AT2104

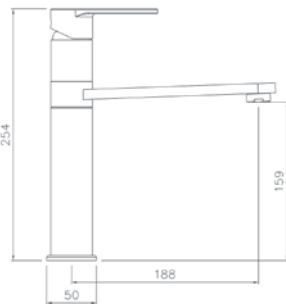

Quantic Chrome  
Min 0.5 bar pressure



CP AT2070

Quantic Matt Black  
Min 0.5 bar pressure



CP AT2105

Quantic Brushed Brass  
Min 0.5 bar pressure



BB AT2182

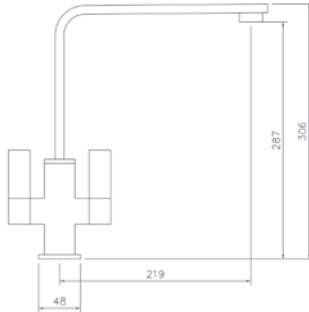

Ratio Pro  
Min 0.5 bar pressure



CP AT1115

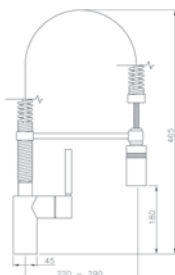

Specto Single Lever  
Min 0.6 bar pressure



CP AT1224

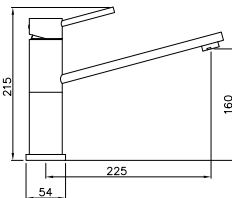

BN AT1225

Tubist Single Lever  
Min 0.75 bar pressure



Tubist Single Lever Pull out  
Min 1.75 bar pressure



Tubist professional Pull around with Spray  
Min 1.5 bar pressure



Tubist T Pull out Spray  
Min 1.75 bar pressure



Zest Pullout Spray  
Min 0.75 bar pressure



ABODE STAINLESS STEEL TAPS

Airo  
Min 0.3 bar pressure

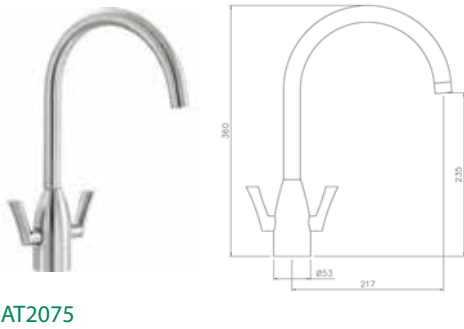

Axial Pot Filler  
Min 0.6 bar pressure

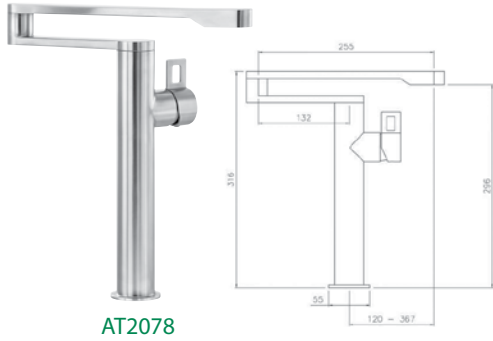

Focal  
Min 0.3 bar pressure



Propus  
Min 0.5 bar pressure



Quala  
Min 0.4 bar pressure

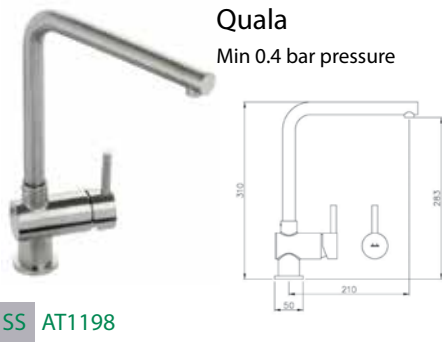



**Stalto**  
Min 0.75 bar pressure

SPRAY

SS AT1199



**Sway**  
Min 0.5 bar pressure

SS AT2178



**Taura**  
Min 0.3 bar pressure

SS AT1137

ABODE CLASSIC TAPS

**Gosford**  
Min 0.2 bar pressure



CP AT1019



BN AT1020



AB AT1022



**Burford**  
Min 0.20 / 5.5 bar pressure



CP AT2170



BN AT2171



BB AT2172

**Ludlow**  
Min 0.2 bar pressure



CP AT1026



AB AT1028



BN AT1216

Material Key	CP: Chrome Plate • BN: Brushed Nickel • AN: Antique Nickel • GB: Granite Black • GW: Gloss White • MB: Matt Black • EG: English Gold • BB: Brushed Brass
	FB: Forged Brass • AB: Antique Brass • SS: Stainless Steel • PW: Pewter • RG: Rose Gold • UC: Urban Copper • CC: Century Copper • GR: Graphite

**Ludlow bridge**  
Min 0.2 bar pressure



CP AT1029



BN AT1217



AB AT1031



**Melford**  
Min 0.3 bar pressure



CP AT1041



AB AT1043



BN AT1044



**Melford bridge**  
Min 0.3 bar pressure



CP AT1045



AB AT1047



BN AT1048



ABODE HANDSPRAYS

**Atlas**  
Min 0.5 bar pressure  
Max 2.0



CP AT1100



BN AT1101



SS AT1107

**Axel**  
Min 0.5 bar pressure  
Max 2.0



CP AT3040



PW AT3041

**Hendon**  
Min 1.0 bar pressure  
Max 2.0



FB AT3101



CC AT3103



swich

The Abode Switch enables you to turn any tap into a filtered water tap. It can be fitted to any tap to make it a water filter tap. Simply turn the dial to choose instant crystal clear filtered water. The Switch comes complete with one water filter cartridge.



CP AT2050  
CP AT2054



BN AT2051  
BN AT2055



MB AT2106  
MB AT2107



BB AT2109  
BB AT2110



BW AT2201  
Classic  
BW AT2202  
High Resin

aquifier

The Abode Aquifier filter taps improve the taste, smell and appearance of drinking water. Aquifier taps offer water filtration with no need for extra levers or a separate tap.

Atlas Aquifier  
Min 0.3 bar pressure

CP AT2003  
BN AT2004



BB AT2098  
MB AT2099



Globe Aquifier Min 1.0 bar pressure



CP AT2173 BN AT2174 BB AT2175 MB AT2176

Gosford Aquifier  
Min 0.3 bar pressure

CP AT2005  
BN AT2006



Naturalé Aquifier  
Min 1.0 bar pressure



PC AT2195-F5 BN AT2196-F5 MB AT2197-F5

Orcus 3 way Aquifier

CP AT2072



Puria Aquifier  
Min 1.0 bar pressure



PC AT2042 BN AT2043 MB AT2044



PRONTEAU™  
by abode

INTRODUCING the HotKey® Collection with PROBOIL.4E

The collection offers an array of stylish designs including; swan and quad spout monoblocs and unique 3 part designs. There are five beautiful finishes available across the collection and all HotKey® taps are supplied with the 4L Proboil.4E boiler and premium water optimisation filter.

STEAMING | STYLISH | SAFE



**INSTANT STEAMING HOT WATER**  
Instant 75-98° controllable and steaming hot water that is perfect for teas, coffees and all of your cooking needs.



**EVERYDAY HOT AND COLD WATER**  
Hot water that is perfect for filling the sink, washing hands and cleaning tasks. Cold water that is ideal for common chores and watering plants.



**INSTANT FILTERED COLD WATER**  
Crystal clear filtered water on tap, that improves the taste of cold drinks by filtering out both hardness and limescale.



**SAFETY IS KEY**  
Your safety plays a key role in our design process. Our innovative HotKey® technology giving you complete controlled access steaming hot water.



PROFILE 3 PART  
4 IN1 MIXERTAP

- H:368mm Min: 0.75 Bar
- PT1007-2 Chrome
  - PT1008-2 Brushed Nickel
  - PT1053 Antique Brass

**Pack Includes**

- Pronteau Mixertap
- PROBoil Boiler
- PROBoil Filter
- Hotkey (x2)



PROFILE 3 PART  
4 IN1 MIXERTAP

- H:330mm Min: 0.75 Bar
- PT1009-2 Chrome
  - PT1010-2 Brushed Nickel
  - PT1054 Matt Black

**Pack Includes**

- Pronteau Mixertap
- PROBoil
- PROBoil Filter
- Hotkey (x2)

PT1107-2



### PROJECT 4 INI MONOBLOC

H:388mm Min: 0.5 Bar

PTI003-2 Chrome  
PTI004-2 Brushed Nickel  
PTI027-2 Matt Black  
PTI052 Brushed Brass

#### Pack Includes

- Pronteau Mixertap
- PROBoil Boiler
- PROBoil Filter
- Hotkey (x2)

*Please Note:* This product comes with a PROBoil.2X boiler.



### PROFILE 4 IN MONOBLOC

H:425mm Min: 0.5 Bar

PTI001-2 Chrome  
PTI002-2 Brushed Nickel  
PTI026-2 Matt Black  
PTI051 Antique Brass

#### Pack Includes

- Pronteau Mixertap
- PROBoil.4E Boiler
- PROBoil Filter
- Hotkey (x2)

*Please Note:* This product comes with a PROBoil.2X boiler.



### PROTHIA SWAN 3 IN MONOBLOC

PTI130 Chrome  
PTI131 Brushed Nickel  
PTI132 Graphite  
PTI133 Matt Black  
PTI134 Urban Copper

**H: 415 SER: 216 SEH: 286 BP: 48**

Requires a minimum operating pressure of 1.5 Bar (cold) and 0.8 Bar (hot)

*Please Note:* This product comes with a PROBoil.2X boiler.



### PROTHIA QUAD 3 IN MONOBLOC

PTI140 Chrome  
PTI141 Brushed Nickel  
PTI142 Matt Black  
PTI143 Brushed Brass  
PTI144 Urban Copper

**H: 352 SER: 201 SEH: 273 BP: 48**

Requires a minimum operating pressure of 1.5 Bar (cold) and 0.8 Bar (hot)

*Please Note:* This product comes with a PROBoil.2X boiler.



### PROPURE QUAD 4 IN MONOBLOC

H:366mm Min: 0.5 Bar

PTI160 Chrome  
PTI161 Brushed Nickel  
PTI162 Matt Black  
PTI163 Brushed Brass  
PTI164 Urban Copper

#### Pack Includes

- Pronteau Mixertap
- PROBoil Boiler
- PROBoil Filter
- Hotkey (x2)

*Please Note:* This product comes with a PROBoil.2X boiler.



### PROPURE SWAN 4 IN MONOBLOC

H:426mm Min: 0.5 Bar

PTI150 Chrome  
PTI151 Brushed Nickel  
PTI152 Matt Black  
PTI153 Brushed Brass  
PTI154 Urban Copper

#### Pack Includes

- Pronteau Mixertap
- PROBoil Boiler
- PROBoil Filter
- Hotkey (x2)

*Please Note:* This product comes with a PROBoil.2X boiler.



### PROTRAD 3 IN MONOBLOC

PTI190 Chrome  
PTI191 Brushed Nickel  
PTI192 Antique Brass

**H: 409 SER: 216 SEH: 284 BP: 60**

Requires a minimum operating pressure of 1.5 Bar (cold) and 0.75 Bar (hot)

*Please Note:* This product comes with a PROBoil.2X boiler.



### PROFESSIONAL 3 IN MONOBLOC

PTI122 Chrome  
PTI123 Brushed Nickel

**H: 515 SER: 245 SEH: 262 BP: 48**

Requires a minimum operating pressure of 1.5 Bar (cold) and 0.8 Bar (hot)

*Please Note:* This product comes with a PROBoil.2X boiler.



### PROSTYLE 3IN MONOBLOC

PTI111 Chrome  
PTI112 Brushed Nickel  
PTI113 Graphite  
PTI114 Matt Black  
PTI115 Urban Copper

**H: 427 SER: 216 SEH: 298 BP: 48**

Requires a minimum operating pressure of 1.5 Bar (cold) and 0.75 Bar (hot)

*Please Note:* This product comes with a PROBoil.2X boiler.



### PROSTREAM 3IN MONOBLOC

PTI101 Chrome  
PTI102 Brushed Nickel  
PTI103 Matt Black  
PTI104 Antique Brass  
PTI105 Urban Copper

**H: 390 SER: 222 SEH: 287 BP: 48**

Requires a minimum operating pressure of 1.5 Bar (cold) and 0.75 Bar (hot)

*Please Note:* This product comes with a PROBoil.2X boiler.

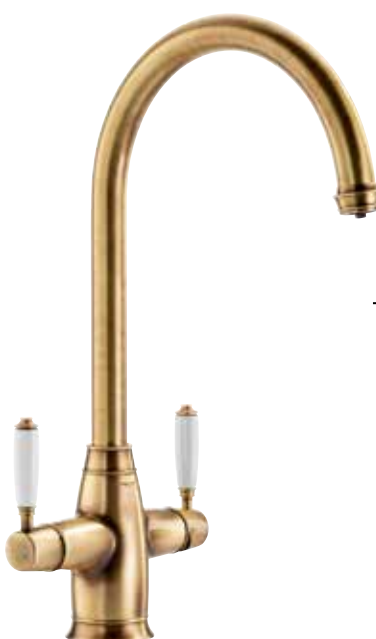

### PROTRAD 4 IN MONOBLOC

H:409mm Min: 0.8 Bar

PTI193 Chrome  
PTI194 Brushed Nickel  
PTI195 Matt Black

#### Pack Includes

- Pronteau Mixertap
- PROBoil Boiler
- PROBoil Filter
- Hotkey (x2)

*Please Note:* This product comes with a PROBoil.2X boiler.

### The Brand New PROBOIL.4E



- The perfect pairing for any Abode sink. The compact PROBOIL.4E boiler will even sit neatly in a Belfast cabinet.

- With a tank capacity of 4 litres this system is perfect for keen cooks or busy households.

- The temperature can be set between 75° & 98°, perfect for specialist teas and coffees which state the optimum brewing temperature.

- A Pronteau support and service team are also on hand should you ever need it.

**Boiler Dimensions**  
22 x 22 x 28cm



### INDUSTRIA 3IN MONOBLOC

PTI196 Brushed Nickel  
PTI197 Matt Black/Brass

**H: 352 SER: 201 SEH: 273 BP: 48**

Requires a minimum operating pressure of 1.5 Bar (cold) and 0.75 Bar (hot)

*Please Note:* This product comes with a PROBoil.2X boiler.

### Say Hello to the PROBOIL.2X



- The perfect pairing for any Abode sink. The compact PROBOIL.2X boiler will even sit neatly in a Belfast cabinet.

- Steaming hot water is dispensed safely via a two stage handle operation.

- Each tap is supplied with both the temperature controllable, 2L PROBOIL.2X boiler and paired filter to protect your boiler and deliver the perfect hot drink.

- A Pronteau support and service team are also on hand should you ever need it.

**Boiler Dimensions**  
20.6 x25.6 x29.1cm





Astbury Single Lever



- CP AT3004
- PW AT3006
- FB AT3070
- CP AT3005
- PW AT3007
- FB AT3071

Min 0.5 bar pressure    Min 1.25 bar pressure

Available in chrome,  
pewter & forged  
brass

Astbury Monobloc



- CP AT3000
- PW AT3002
- FB AT3068
- CP AT3001
- PW AT3003
- FB AT3069

Min 0.4 bar pressure    Min 1.25 bar pressure

Integrated Handspray

Astbury Bridge

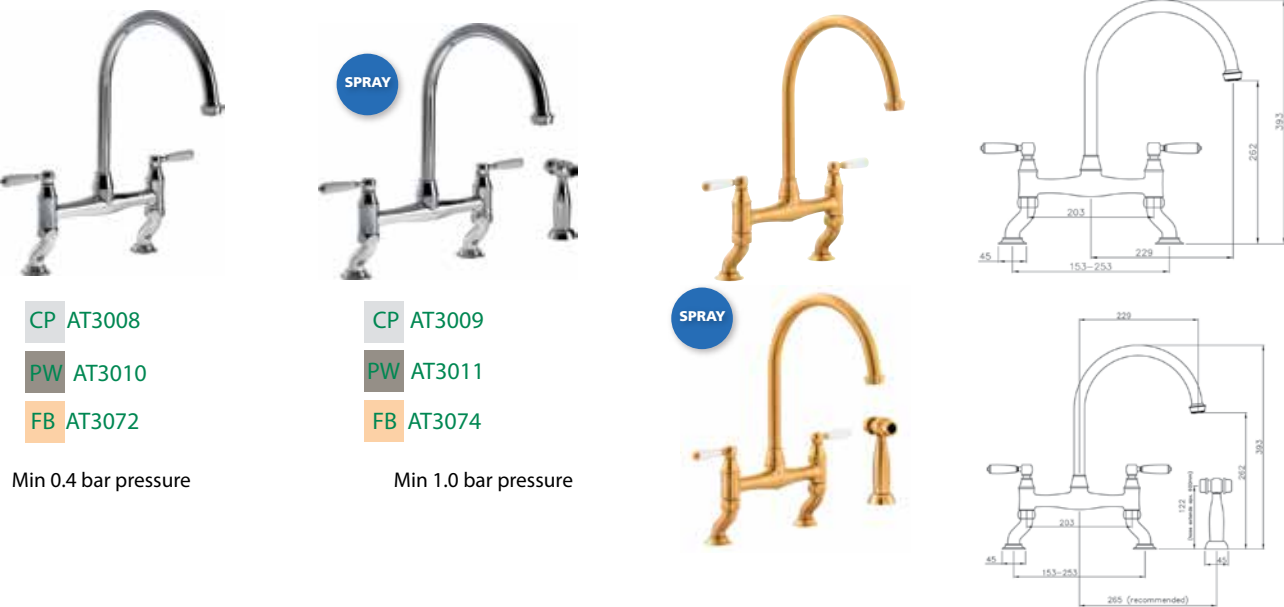

- CP AT3008
- PW AT3010
- FB AT3072
- CP AT3009
- PW AT3011
- FB AT3074

Min 0.4 bar pressure    Min 1.0 bar pressure

**Material Key**  
CP: Chrome Plate • BN: Brushed Nickel • AN: Antique Nickel • GB: Granite Black • GW: Gloss White • MB: Matt Black • EG: English Gold  
FB: Forged Brass • AB: Antique Brass • SS: Stainless Steel • PW: Pewter • RG: Rose Gold • UC: Urban Copper • CC: Century Copper • GR: Graphite

Non Integrated Handspray

Astbury Three Hole Mixer Hole  
Min 0.4 bar pressure



CP AT3046



PW AT3047



FB AT3073

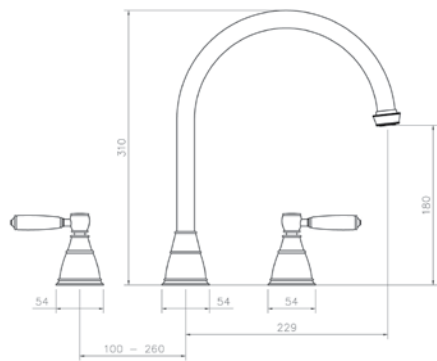

Astbury Three Hole Mixer Hole  
with Hendon Handspray

Min 1.0 bar pressure



CP AT3050



PW AT3051

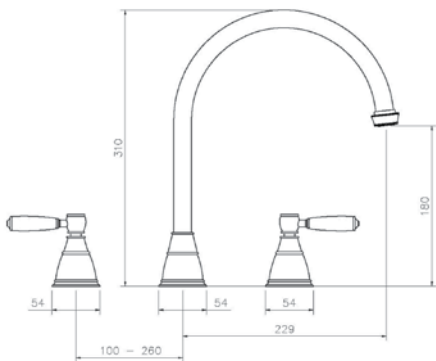

FB AT3075

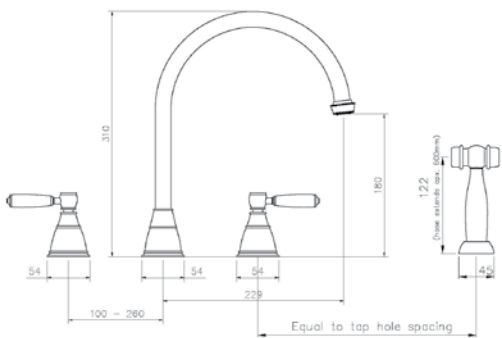



Brompton Monobloc



CP AT3012  
PW AT3014

CP AT3013  
PW AT3015

Min 0.4 bar pressure    Min 1.25 bar pressure

Integrated Handspray

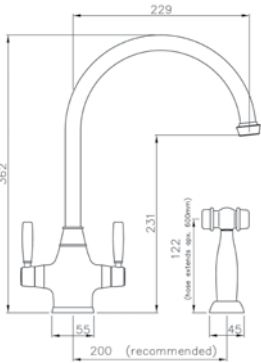

Brompton Single Lever

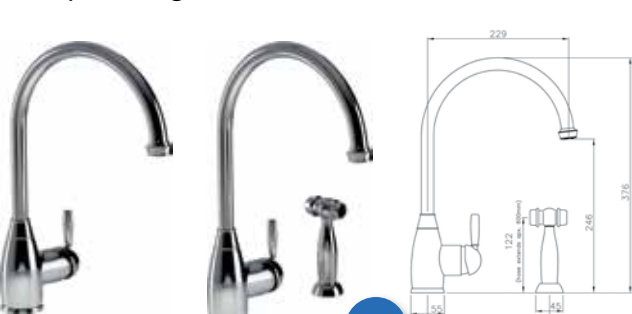

CP AT3016  
PW AT3018

CP AT3017  
PW AT3019

Min 0.5 bar pressure    Min 1.25 bar pressure

Non Integrated Handspray

Brompton Bridge



CP AT3020  
PW AT3022

CP AT3021  
PW AT3023

Min 0.4 bar pressure    Min 1.0 bar pressure

Brompton Three Hole Mixer    Min 0.4 bar pressure



CP AT3044

PW AT3045

Brompton Three Hole Mixer with Hendon Handspray    Min 1.0 bar pressure



CP AT3048

PW AT3049

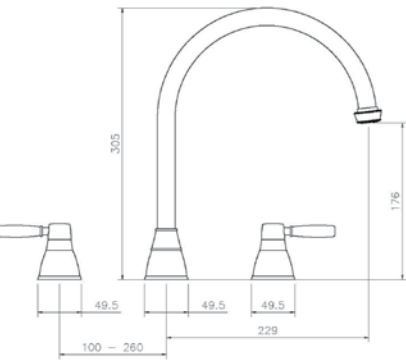

Bayenne Single Lever



CP AT3028  
PW AT3030

CP AT3029  
PW AT3031

Integrated Handspray

Bayenne Monobloc



CP AT3024  
PW AT3026

CP AT3025  
PW AT3027

Bayenne Monobloc

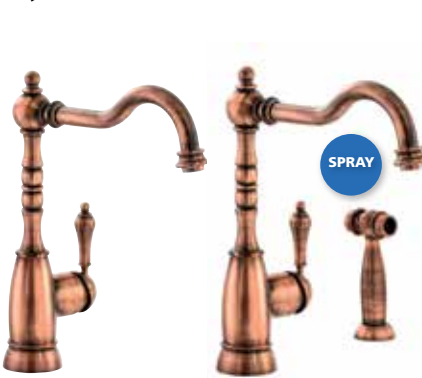

CC AT3087  
Min 0.5 bar pressure

CC AT3088  
Min 1.5 bar pressure

Integrated Handspray



CC AT3090  
Min 0.5 bar pressure

CC AT3086  
Min 1.5 bar pressure

Bayenne Bridge



CP AT3032  
PW AT3034

CP AT3033  
PW AT3035

Min 0.4 bar pressure    Min 1.0 bar pressure

Non Integrated Handspray



CC AT3089  
Min 0.4 bar pressure

CC AT3091  
Min 1.0 bar pressure

Replace the kettle with this safe, steaming hot water tap ideal for making tea, preparing pasta, cleaning dishes, blanching vegetables, warming a baby's bottle or for any other activity that requires the use of steaming hot water. This tap can be mounted either on a work surface or a sink and simply requires an electrical socket and uses less energy than a 40W lightbulb! 2 year warranty

Hot and Cold Filtered Water Taps



HC3300CP HC3300BS

**3300 Series**  
Dispenses instant 98oc hot and cold filtered water. Adjustable temperature dial. Hot push-lever locking mechanism. Produces 100 cups per hour. Single handle.



HC1100CP HC1100BS

**1100 Series**  
Dispense 98oc hot and cold filtered water. Shut off valve to automatically stop flow of water. Produces approximately 100 cups per hour. Adjustable temperature dial.

Insinkerator Hot Filtered Water Taps



H3300CP H3300BS

**3300 Series**  
Dispenses instant 98oc hot filtered water. Adjustable temperature dial. Hot push-lever locking mechanism. Produces 100 cups per hour. Single handle.



GN1100CP GN1100BS

**1100 Series**  
Dispense 98oc hot filtered water. Shut off valve to automatically stop flow of water. Produces approximately 100 cups per hour. Adjustable temperature dial.



3N1C 3N1BS 3N1AN

**3N1 SERIES**  
Dispenses filtered steaming hot water. Self closing hot water handle with easy grip



**Replacement Filter**  
**F-701R** £104 (pack of two)  
Replacement water filters are designed exclusively for use with the InSinkErator Steaming Hot Water Tap system. It is a chlorine, taste and odour filter with additional lead protection and a scale reduction capability. It filters sediment at a 5 micron level.

**Showroom Collection** Dispenses filtered steaming hot water up to 98 degrees C, as well as regular hot & cold water.

3N1 SERIES 'L' Shape



3N1LBV 3N1JB



3N1G

'J' Shape



3N1JBV 3N1JC



3N1JBS



3N1JRG

4N1 SERIES Hot, Cold, Filtered Hot & Filtered Cold Taps - Touch Tap

'L' Shape



4N1LBV 4N1LC



4N1LB



4N1JC



4N1JB



4N1BV

'U' Shape



4N1UC



4N1UB



4N1UBV

Black J Shape



H3300B



HC3300B

HOT WATER TAPS

Please take care when running very hot water into cold ceramic sinks, as this may cause thermal shock and damage the sink. It is suggested that warm water be run first to avoid such an eventuality

Colour Key

CP/C: Chrome • BS: Brushed Steel • G: Brushed Gold • RG: Rose Gold • AN: Anthracite • JB: Black

KOHLER kitchen taps are designed for life, you can count on them to be leak-free and reliable year after year. As tough as they are beautiful, KOHLER taps feature finishes that are 2 x stronger than the industry standard, so they look brand new even after years of use. Aerated stream of water that's great for quickly filling pots and gentle enough to clean delicate berries.

**Kohler Taps Material key:**

CP – Polished Chrome	S – Polished Stainless
G – Brushed Chrome	BS – Brushed Stainless
VS – Vibrant Stainless	BV – Vibrant Brushed Bronze
SN – Vibrant Polished Nickel	BN – Vibrant Brushed Nickel
	BL – Matte Black

Aleo AP  
Min 0.5 bar pressure



99176W-4-CP

Clairette Min 1.8 bar pressure



692W-G  
While stocks last

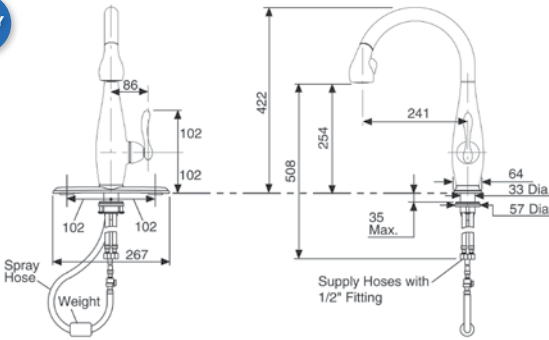

Evoke  
Min 1.0 bar pressure



6333-CP  
While Stocks Last



6333-VS  
While Stocks Last



6333-BL  
While Stocks Last

Hirise Monobloc  
Min 1.0 bar pressure

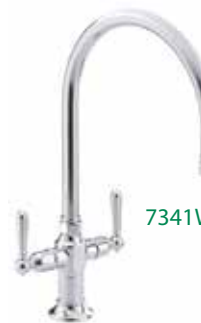

7341W-4-S

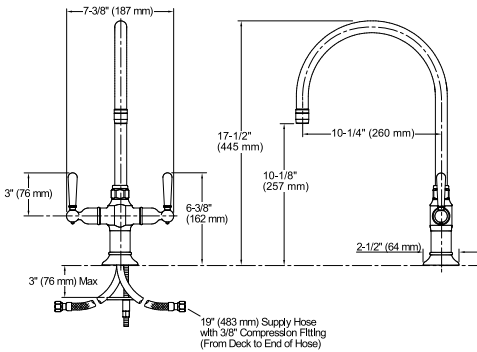

Hirise Deck Mount Pot Filler  
Min 1.0 bar pressure



7323W-4-S



7323W-4-BS

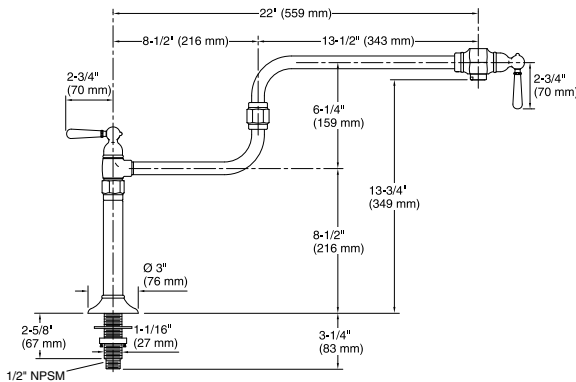

Parq Bridge Tri Handle Min 1.0 bar pressure



C6130-3-CP

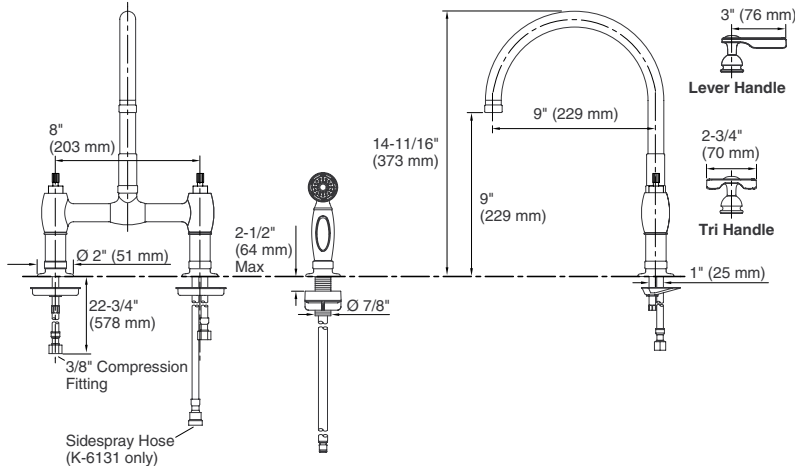

Purist Min 0.4 bar pressure



7507-CP

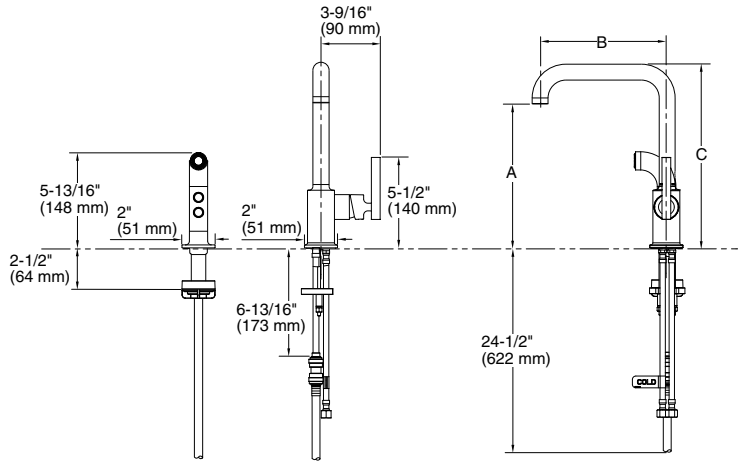

Purist Bridge Mixer Min 1.0 bar pressure



7547-4-CP

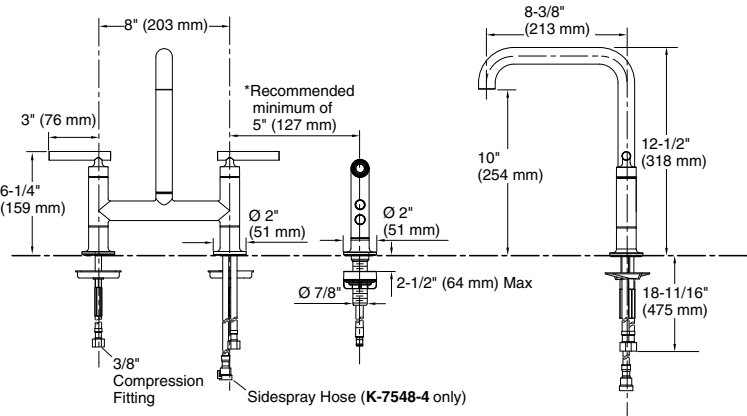



Simplice Tall  
Single tap hole  
Min 1.5 bar pressure



C596-BL  
While Stocks Last

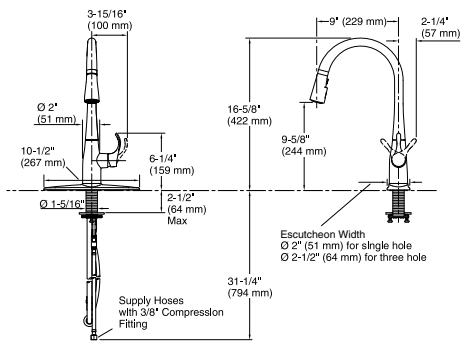

Simplice  
Two tap hole  
Min 1.0 bar pressure



C647-VS  
While Stocks Last

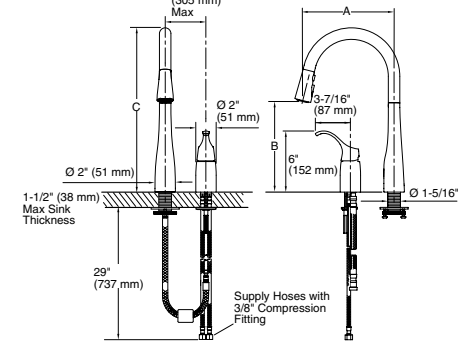

Simplice  
Single tap hole  
Min 1.0 bar pressure



C597-BL  
While Stocks Last

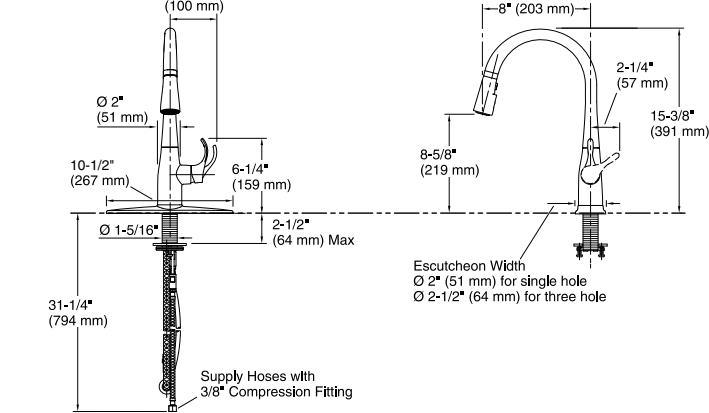

Vinnata  
Min 1.8 bar pressure



690W-SN  
While stocks last

Lansdowne taps are excellent quality and have been carefully designed to perform in every household with adequate flow even with a very low pressure of 0.1. Lansdowne taps also have an excellent stream pattern.  
Lansdowne taps are available in a variety of finishes to suit your kitchen design, polished chrome, brushed nickel and polished brass.

Clarendon Bridge Capstan



ZV/CLARE/BR/C/BN

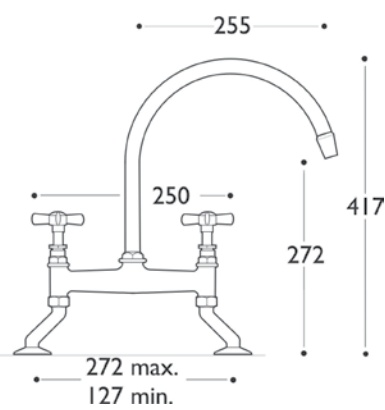

Clarendon Bridge Lever



ZV/CLARE/BR/L/BN

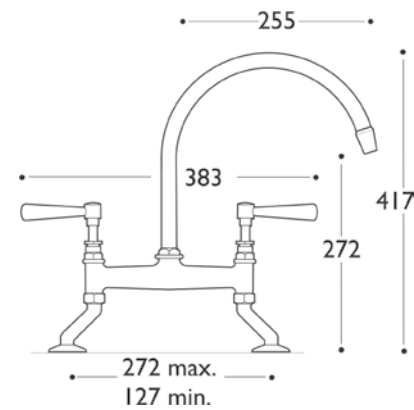

Heron



ZV/HERON/BN  
While stocks last

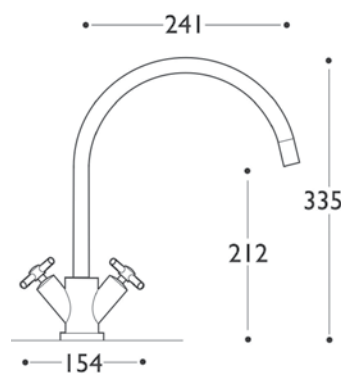

We are please to confirm that we have been appointed as a distributor for the Perrin & Rowe kitchen range.

Please contact the sales office who will be happy to discuss their products and prices or visit our website at [www.kitchensinkco.com](http://www.kitchensinkco.com) to view their range



## RUDGE TAPS - ARUNDEL & CHICHESTER



### AR3006

Deck Two Hole Crosstop Mixer  
Weathered Copper



### AR3010

Crosstop Monobloc Mixer  
Weathered Copper



### CH3006

Deck Two Hole Crosstop Mixer  
Chromium Plate  
Weathered Copper



### CH3010

Crosstop Monobloc Mixer  
Brushed Nickel



### CH3018

Three Hole Crosstop Mixer  
Chromium Plate  
Weathered Copper

While Stocks Last

A combination of timeless style and precision engineering ensures they not only look stunningly beautiful, but perform to perfection, making them the perfect partner for our range of artisan, handcrafted sinks.



HAMBLETON  
FTTP0019 NICKEL

Deck mounted bridge mixer with porcelain levers and Shaws ceramic hot and cold undices, ¼ turn ceramic valve sand extended length flexible tail pipes for easy installation. Minimum 0.2 bar pressure required.

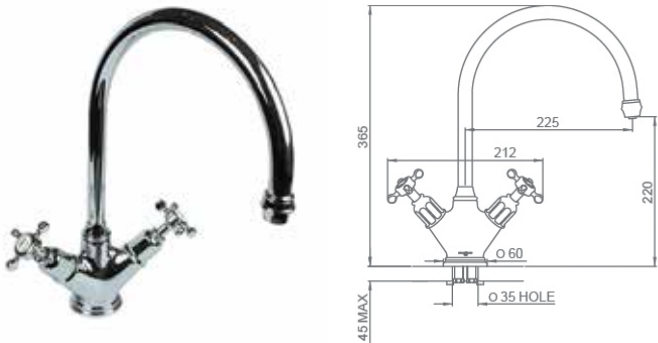

ELSWICK  
FTTP0014 CHROME  
FTTP0016 NICKEL

Monobloc sink mixer with crosshead handles and Shaws ceramic hot and cold undices, ¼ turn ceramic valves and extended length flexible tail pipes for easy installation. Minimum 0.2 bar pressure required.

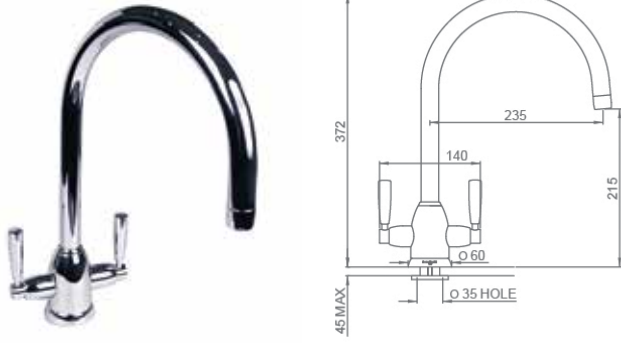

SILVERDALE  
FTTP0007 CHROME

Monobloc sink mixer with crosshead handles and Shaws laser etched hot and cold undices, ¼ turn ceramic valves and extended length flexible tail pipes for easy installation. Minimum 0.2 bar pressure required.

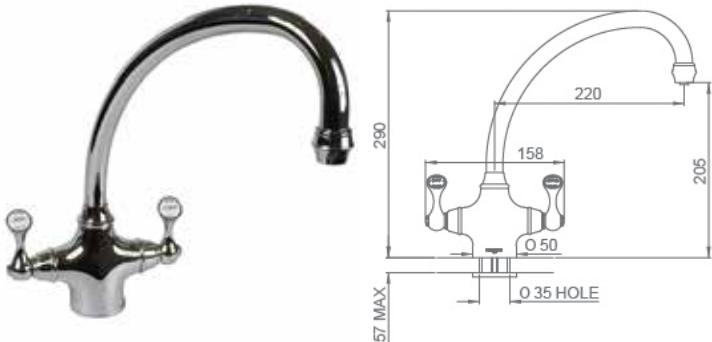

WHITEWELL  
FTTP0011 CHROME

Monobloc sink mixer with porcelain levers and Shaws ceramic hot and cold undices, ¼ turn ceramic valves and extended length flexible tail pipes for easy installation. Minimum 0.2 bar pressure required.

EVOLUTION 250 (Showroom Collection)



**ISEEVO250**  
High-torque Dura-Drive induction motor with Ultra-quiet technology. 3 stage grind technology with Auto-reverse grinding action. Built-in air switch in black, chrome or brushed steel. Deluxe polished chrome stopper cover. New style trim shell. Stainless Steel grind elements and chamber. Overload protection and QuickLock mounting assembly for easier installation. 8 year parts and service guarantee.

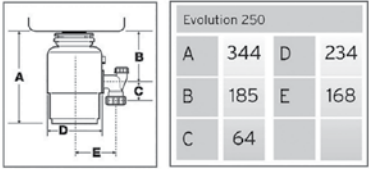

EVOLUTION 150 (Showroom Collection)



**ISEEVO150**  
0.75 horsepower. Grind Chamber Capacity - 1005ml. Evolution quiet technology. 2-stage grind technology. Built in Air Switch. Stainless Steel Strainer Basket Can accommodate Cover Control accessory. 7 year parts and labour guarantee.

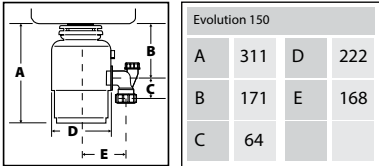

EVOLUTION 75 (Showroom Collection)

Not suitable for batch feed conversion



**ISEEVO75**  
The E75 food waste disposer features a new style black and silver trim shell with a premium stainless steel sink stopper. It has a compact, space saving design. Supplied with built-in air switches in matte black, chrome and brushed steel it is supported by a 6 year parts and service guarantee.



The Air Switch button is available in three colour choices. Premium stainless steel stopper with cover.

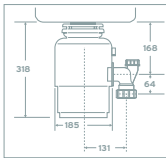

SPECIFICATIONS

Type of feed	Continuous
On/Off Control	Wall switch or built-in air switch
Motor	Single phase
Reversing	None
Time Rating	Intermittent
Lubrication	Permanently lubricated upper & lower bearings
Shipping Weight (Approx.)	8.2kg
Unit Finish	Black
Overall Height	318mm
Grind Technology	1-stage grind technology
Sound Technology	None
Grind Chamber Capacity	980ml
Motor Protection	Manual reset overload
Average Water Usage	Approximately 4.0L per person per day
Average Electrical Usage	3-4KWH per annum
Drain Connection	Yes
Dishwasher Drain Connection	Yes

Volts/Hz	HP	Average load
220-240V, 50-60Hz	.75 (@240V/ 50Hz)	405 W



INSINKERATOR FOOD WASTE DISPOSERS

MODEL 66



0.75 horsepower, 1 stage stainless steel grinding system (980ml) with quiet sound reduction technology.  
One piece stainless steel stopper and removable easy clean sound baffle.  
Built in air switch and 4 year guarantee

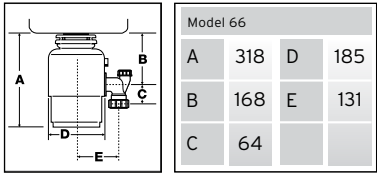

MODEL 56



0.55 horsepower, 1 stage stainless steel grinding system (980ml) with standard sound reduction technology.  
Plastic stopper and removable easy clean sound baffle.  
Built in air switch and 3 year guarantee

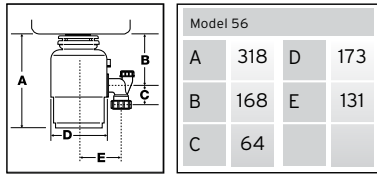

MODEL 46



0.55 horsepower, 1 stage galvanized steel grinding system (980ml) with basic sound reduction technology.  
Plastic stopper and 2 year guarantee.

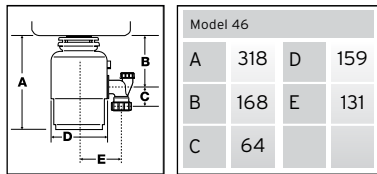

ACCESSORIES

AIR SWITCH



ISEAIRSWITCH

For continuous feed units only.

EXTENDED FLANGE



ISEEXTSS

For continuous feed units only.  
For use with sinks greater than 20mm thickness.  
Stainless steel finish.

BATCH FEED KIT COVER CONTROL



ISEBFK

For Evolution models 150 & 250. Not suitable for Evolution 75.

SINK WASTES

Wastes for Kohler and Villeroy & Boch sinks



1 x 90mm waste & 1 x overflow  
KSC1SS  
KSC1BC  
KSC1NTB



2 x 90mm wastes & 2 x overflows  
KSC2SS  
KSC2BC  
KSC2NTB



1 x 90mm waste & 2 x overflows  
KSC1-5SS  
KSC1-5BC  
KSC1-5NTB

Wastes for Regis and Kohler sinks

1 x 90mm waste & 1 x rectangular overflow  
KSC3SS  
KSC3BC

1 x 60mm waste (\*extra long bolt)  
KSC6SS\*  
KSC6NTB\*

1 x 60mm waste & 1 x overflow  
KSC5SS  
KSC5PC  
KSC5BC  
KSC5NTB

1 x 90mm waste (extra long bolt)  
KSC7SS  
KSC7NTB

1 x 90mm waste, 1x 90mm Bolt,  
1x 'T' piece stainless steel  
KSC9SS

1 x 90 mm waste  
KSC8SS  
KSC8BC  
KSC8NTB

\*extra long bolt

Long (90mm) bolt

BRBOLT90

Replacement Baskets



Replacement 90mm basket grid  
BWSTSS-TOP

Replacement 90mm basket grid  
old style  
BASKET



Replacement 90mm basket grid  
BWSTPVD-TOP

SINK SUNDRY ITEMS

Plumbing kits



Single bowl plumbing kit  
PLUMBKIT1



Double bowl plumbing kit  
PLUMBKIT2

Double bowl with extension  
PLUMBKIT3



Double bowl spacesaving plumbing kit  
PLUMBKIT4

Single bowl spacesaving plumbing kit  
PLUMBKIT5

Overflow kit

Round overflow kit only  
O/FLOWKITSS  
O/FLOWKITNTB  
Round overflow kit with T piece  
O/FLOWKITSS  
O/FLOWKITNTB

Rectangular overflow kit only  
(48 x 26 mm plate)  
O/FLOWKITCP

Overflow blanking plate  
BLANK

Cermaic repair kit



CRAMERWHITE

SUNDRY INFORMATION

CARE INSTRUCTIONS

The use of plastic bowls is NOT recommended as scratching of the surface may occur. Small particles of grit or bone may become embedded in the base of the bowl and can rub on the sink surface. A lightweight plastic draining mat can be used to protect the sink basin when large trays or saucepans are being cleaned and should be removed after use.

Taps or wastes with a non-tarnish plated finish should only be cleaned with a mild soap solution such as Fairy Liquid or a mild cream like Cif. Neat bleach or strong abrasive cleaners should never be used on any plated products. For this reason we cannot guarantee wastes after they have been fitted. Plated wastes and taps should always be wiped dry with a soft cloth after use.

CARRIAGE CHARGES

Orders under £350 net or where required next day may incur a small order charge.  
Please check with sales office.  
Please note a charge will be made if delivery is in a Congestion area or Ultra Low Emissions Zone.

RETURNS

Goods returned must be in the original packaging complete with all templates, fitting instructions and parts. They may be subject to a 15% re-stocking charge.

SPECIAL ORDERS – COLOURED SINKS

Whilst the white versions of sinks are generally held in stock, the colour options are generally not.  
We would advise on checking lead times (these can be 12- 16 weeks) and availability prior to placing your order for a coloured sink.  
Once the order for a coloured sink has been placed this order cannot be cancelled.

CERAMIC SINK DIMENSIONS

Due to the firing process, Ceramic Sink dimensions may vary by +/- 2% to 3%.  
Please do take this into account when making bespoke furniture.

HOT WATER TAPS

Please take care when running very hot water into cold ceramic sinks, as this may cause thermal shock and damage the sink.  
It is suggested that warm water be run first to avoid such an eventuality







# **SALES AND ENQUIRIES**

## **01243 841332**

**EMAIL: [sales@kitchensinkco.com](mailto:sales@kitchensinkco.com)**

**[www.kitchensinkco.com](http://www.kitchensinkco.com)**

**10 EVANS PLACE • BOGNOR REGIS • WEST SUSSEX • PO22 9RY**



*The Regis Range*



THE BOLD LOOK  
OF **KOHLER**



abode

